



Asistal AR



UYGULAMAMIZI İNDİRİN
DOWNLOAD OUR APP

ASISTAL
aluminium profiles company

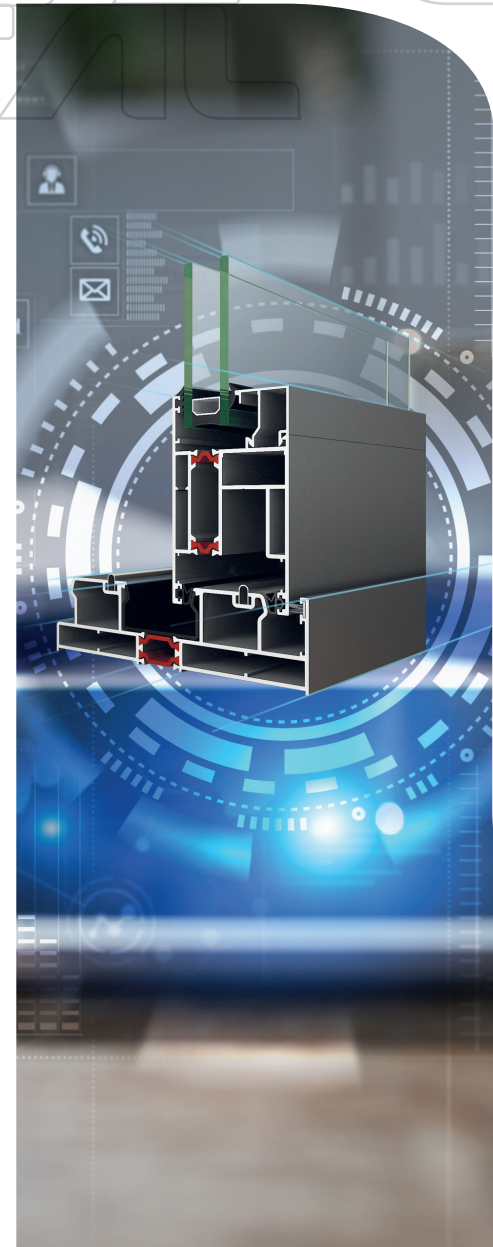

Alüminyum mimari çözümler...
Aluminum architectural solutions...



Artırılmış gerçekliği

Asistal AR uygulaması ile ürünleri istediğiniz açıdan görebileceğiniz, sanal gerçekliği yaşayın..

keşfedin!

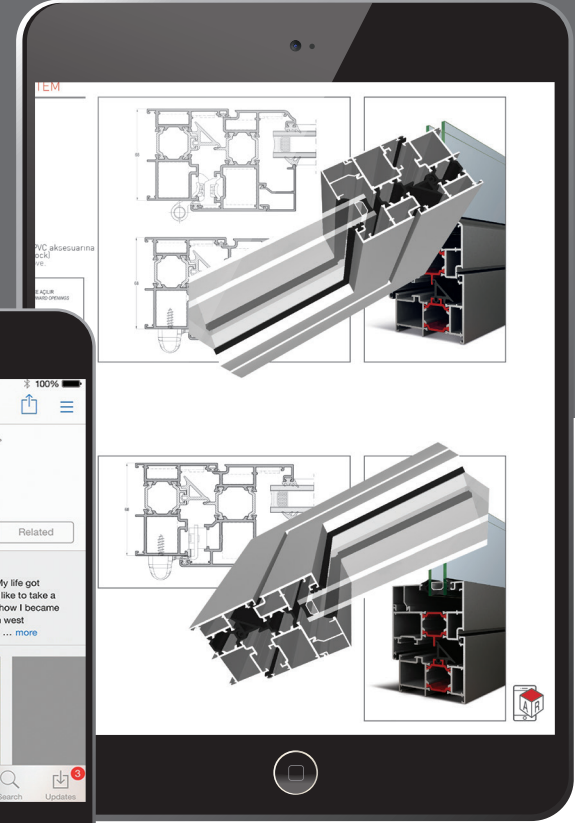

1 Akıllı telefon veya tabletinizde yer alan Google Play veya App Store üzerinden ASISTAL AR uygulamasını indirin.

Download our application ASISTAL AR using your platform Google Play or App Store from your smart phone or tablet.



2 Yanında AR logosu bulunan resmin olduğu sayfaya kameranızı yaklaştırın.

Focus the page identified by the AR logo.

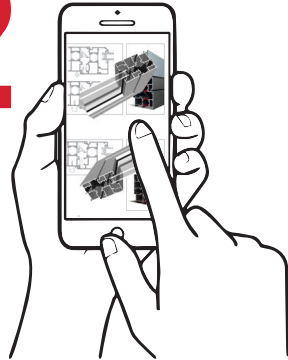

3 ASISTAL tarafından geliştirilen sisteme ait 3D görüntü ekranda belirecektir. Ekran üzerinde kaydırma yaparak 3D görüntüyü döndürüp her açıdan görüntüleyebilirsiniz. 3D image will appear on the screen of the system developed by ASISTAL. By scrolling across the screen, you can rotate the 3D image and view it from any angle.

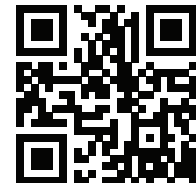
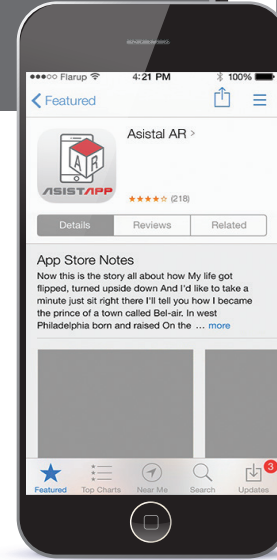
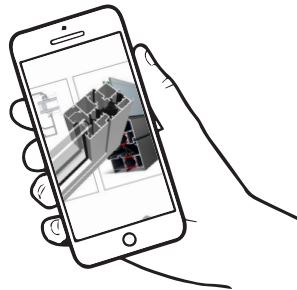

Asistal AR UYGULAMAMIZI İNDİRİN
DOWNLOAD OUR APP

index

YÖNETİM MANAGEMENT	2
ÜRETİM PRODUCTION	4
KALİTE QUALITY	6
ÇEVRE ENVIRONMENT	8
REFERANSLAR REFERENCES	10
ÜRÜNLER PRODUCTS	
AS42, AS50	14
C55, C60	15
TE56, TE62	17
TH55, TM55	19
TH62, THS62	20
TH68, THS68	21
TH78, THS78	22
TH62-HV, TH68-HV	23
SL28, SL32	24
SL40, SL40T	25
SL38T-K	26
SL38T-N	27
LS60-K, LS60-N	29
FDT62	30
FC50-AS	32
FC50-AST	33
INTERNO 85, INTERNO 42, INTERNO KAPI	35



1994 yılında kurulan ve Türkiye'nin hatırı sayılır alüminyum üreticileri arasına girmeyi başarmış Asistal Alüminyum, üretim merkezi olarak Kırklareli'ni seçmiştir. Organize Sanayi bölgesi içinde 44.000 m² lik açık, 19.000 m² lik kapalı alanda üretim yapmaktadır.

Yönetim, depo ve sevkiyat faaliyetlerini Çorlu merkez olmak üzere, Tekirdağ, Edirne, İstanbul, İzmir ve Bulgaristan'ın başkenti Sofya şubeleri ile Avrupa'daki eşdeğer üreticilere örnek gösterilecek uluslararası standartlara uygun olarak hizmet vermektedir.

Ayrıca teknolojik yenilikleri yakından takip ederek üretim parkını geliştirmeyi, her biri kendi dalında deneyimli ve eğitilmiş uluslararası uzman kadrosu ile insana ve çevreye saygılı kaliteli üretimi, kendine prensip edinmiştir.

Müşteri memnuniyeti ve kaliteden ödün vermeden, bilgi ve teknoloji yatırımlarını sürdürerek geleceğe güvenli adımlarla ilerleyen Asistal Alüminyum, sektörün gereksinimlerini her geçen gün daha üst seviyeye çıkarmaya ve müşterilerinin beklentilerini "mükemmeliyetçilik" anlayışı içinde karşılamaya devam etmektedir.

Founded in 1994, Asistal Aluminum has become one of the significant aluminum manufacturers in Turkey and selected Kırklareli for its production plant. It continues its manufacturing activities in 44.000 m² outdoor and 19.000 m² indoor area.

It continues its administrative, warehouse and shipment activities and provides service in accordance with international standards, which set examples for other equivalent manufacturers, in Çorlu Head Office and branches in Tekirdağ, Edirne, İstanbul, İzmir and Sofia, capital city of Bulgaria.

It has also taken as principle developing its manufacturing area by following up technological innovations, its international team of experts, who are experienced and trained in their fields and through quality production, with respect for humans and the environment.

Progressing securely towards the future without compromising customer satisfaction and quality and continuing to invest in information and technology, Asistal Aluminum continues to increase the requirements of the sector to a higher level everyday and to meet the expectations of its customers with "perfectionism" concept.



Üretim Production

Temel politikası, üretimden başlayıp son kullanıcıya ulaşana kadar ürünleri ile ilgili tüm süreçleri takip etmektir. Ürün güvenliği, sağlık, çevre ve iş güvenliği duyarlılığı ilkelerini benimseyerek tam bir müşteri memnuniyeti sağlamaktır.

EKSTRÜZYON

1 adet 4 inç 700 tonluk, 1 adet 7 inç 1.630 tonluk, 1 adet de 8 inç 2.200 tonluk 3 farklı kuvvet ve büyüklüğe sahip pres ile farklı ebatlarda profil üretim talepleri karşılanmaktadır.

Aylık 1.200 ton, yıllık 14.400 ton üretim kapasitesine sahip fabrikada EN AW 6060-6063, EN AW 6082-6005-6061 alaşımlarının yanı sıra EN AW 3003 ve EN AW 5754 gibi özel alaşımlarla da üretim yapılabilmektedir.

YÜZEY İŞLEME

7 mt kadar profillere eloksal kaplama yapılabilen tesiste, eloksal kaplama kapasitesi aylık 1.200 ton, yıllık 14.400 ton dur.

Boyahanede, 7 mt ye kadar profillere elektro statik toz boya yapabilmektedir. Aylık boyama kapasitesi 750 ton, yıllık ise 9.000 tondur.

7 mt kadar profillere ahşap transfer yapabilmektedir. Aylık ahşap transfer kaplama kapasitesi 150 ton, yıllık ise 1.800 tondur.

Its main policy is to monitor all processes, related to the products, from the production stage to delivery to end users and to ensure full customer satisfaction by adopting the principles of product safety, health, environmental and work safety awareness.

EXTRUSION

Profile production in different dimensions are carried out with 3 different extractors with different power and size; 1 4 inch 700 tons, 1 7 inch 1.630 tons and 1 8 inch 2.200 tons.

Production is also carried out with such special alloys as EN AW 3003 and EN AW 5754, in addition to EN AW 6060-6063 and EN AW 6082-6005-6061 alloys at the plant, which has a capacity of 1.200 tons per month and 14.400 tons per year.

SURFACE PROCESSING

Monthly anodic oxidation coating capacity of the plant, which can make anodic oxidation coating on profiles up to 7 m, is 1.200 tons and it is 14.400 tons per year.

Electrostatic powder coating is carried out on profiles up to 7 m in the coating plant. Its monthly coating capacity is 750 tons and yearly coating capacity is 9.000 tons.

Wood transfer can be made to profiles up to 7 m. Wood transfer capacity is 150 tons per month and 1.800 tons per year.



Dünya standartlarında üretim...
Production at World standards...





Dünyanın kabul ettiği kalite...
Quality, accepted by the world...



Kalite Quality

Standartlara uygun, kanun, yönetmelik ve tüzüklere AB direktiflerine sadık kalarak, sürekli iyileştirme ile destekleyerek güçlendirir.

Asistal Alüminyum, Balkanlar başta olmak üzere, Avrupa, Orta Doğu, Amerika ülkeleri dahil 30'a yakın ülkeye ihracat yapmaktadır. Dünyanın her noktasına ihracat yapabilmek için gerekli olan standardizasyon ve sertifikalara sahiptir.

Müşteri beklentilerini karşılamayı ve çalışanların mutluluğunu amaçlayan toplam kalite sisteminde, ISO 9001 üretimde iyi imalat koşulları ve ürün kalitesinde ulusal ve uluslararası standartlar uygulamaktır.

Quality is increased by continuous improvement by abiding by the standards, laws, regulations and codes and EC directives.

Asistal Alüminyum exports its products to close to 30 countries, primarily to Balkans and Europe, The Middle East and American countries. It has the necessary standardization and certificates, necessary to export throughout the world.

Total quality system, which aims to meet customer expectations and happiness of employees, applies good manufacturing conditions and national and international standards in product quality in ISO 9001 production.



Çevre Environment

Asistal Alüminyum, ürünlerinin kaliteli olmalarının yanısıra, üretimden son kullanıcıya kadar daima en verimli ve çevreye, insana ve doğaya en duyarlı yöntemlere öncelik verir.

Doğal kaynak kullanımında çevreye saygılı olan Asistal Alüminyum, atık miktarını önleyecek ve azaltacak geri dönüşümü sağlayarak gerekli tüm çalışmaları yapar, çevreyi korur, iş sağlığı ve iş güvenliğine önem verir.

15 m³/saat kapasiteli (360 m³/gün) kimyasal arıtma ünitesi ile geri kullanılabilir su elde edilebilen tesisi ile müşteri taleplerini benimser uygular.

Kuruluşundan beri "İnsan Sağlığında Emniyetin Simgesi" olan Asistal Alüminyum, gelişen ürün ve üretim teknolojisini, kaliteli çalışma ortamını, sürekli eğitimle desteklenen çalışanları ile birlikte pazardaki rekabet gücünü arttırmayı ve sektöründe yurt içinde olduğu gibi yurt dışında da lider marka olmayı hedeflemektedir.

Asistal Alüminyum always prioritizes the most efficient methods, which are the most conscious towards the environment, humans and the nature from production to end users in addition to manufacturing high quality products.

Asistal Alüminyum, respects the environment in using natural resources and strives to decrease the amount of waste and ensures recycling and protects the environment and places emphasis on the work health and safety.

It adopts and applies customer demands with its plant with chemical treatment unit, which can produce recycled water with a capacity of 15 m³/hour (360 m³/day).

Having become the "Symbol of Safety in Human Health" since the day it was founded, Asistal Alüminyum aims to increase its competitive power in the market and to become the leading brand abroad, as it is in Turkey, with its continuously improving production technology, quality working environment and its employees which are supported by training continuously.





Çevreye saygılı üretim..
Environment friendly production..

Referanslar References

TUAL ADALAR	TH62
ISPARTAKULE EVLERİ	TH62, FC50
TEKİRDAĞ VERGİ DAİRESİ	FC50, TH62
EDİRNE RAMADA OTELİ	FC50 , TH62
KEŞAN GENÇLİK MERKEZİ	FC50, TH62, Güneş kırıcı profiller
NAMIK KEMAL ÜNİV. HAST.	FC50, Güneş kırıcı profiller
ÇORLU SANAYİ VE TİCARET ODASI	FC50
GOLDEN LIFE ÇORLU	LS60
DANIŞ TOWER ÇORLU	FC50
KEŞAN SARAL CITY	FC50
VENEZIA PROJESİ	TH62 Gizli Kanat Sistemi , Standart ve Özel tasarım küpeşte profilleri
AYAZMA PROJESİ	Özel profiller, TH55 , FC50
VAHDETTİN KÖŞKÜ (Başbakanlık Konutu)	FDT62
AKTAR YAPI VİLLA	Cam Küpeşte sistemi
BEYLİKDÜZÜ WEST SİDE PROJESİ	Kare küpeşte profilleri, Kompozit Levha
MİLENYUM KONAKLARI	Pergola sistemi
MAXIMOON PROJESİ	AS55, Kompozit Levha
SEA PEARL PROJESİ-ATAKÖY	Cam küpeşte sistemi
ACIBADEM HASTANELERİ	Ofis Bölme ve İç Kapı sistemleri
EDİRNE KAPALI YÜZME HAVUZU	FC50 , TH62, C55
KIPTAŞ MALTEPE EVLA PROJESİ	Küpeşte Profilleri, C55 , TH55
KIPTAŞ ÇATALCA KONUTLAR	FC50 , C55 , TH55
KIPTAŞ VADİTEPE BAHÇEŞEHİR	Küpeşte profilleri
SİNPAŞ ALTINORAN	Projeye özel küpeşte ve denizlik profilleri
SİNPAŞ AQUACITY DENİZLİ	Denizlik profilleri
AĞAOĞLU MASLAK 1453	Küpeşte profilleri
KULLAR İNŞAAT HARAMİDERE	FC50, TH62
AKRONES TERMAL OTEL-AFYON	Küpeşte profilleri, C55 , TH55
ÇİMSA – AFYON SOSYAL TESİSİ	TH62
AYDIN ÜNİVERSİTESİ EK BİNASI	FC50, Ofis Bölme sistemleri
İTÜ MASLAK YURT KONUTLARI	Kare küpeşte profilleri
KURTKÖY ADATIP HASTANESİ	Özel profiller, FC50
MERİT ROYAL KIBRIS	
PANAMA OTEL PROJESİ	
TUAL ADALAR	TH62
ISPARTAKULE EVLERİ	TH62, FC50
TEKİRDAĞ TAX OFFICE	FC50, TH62
EDİRNE RAMADA OTEL	FC50 , TH62
KEŞAN YOUTH CENTER	FC50, TH62 , Sun Shading Profiles
NAMIK KEMAL UNIVERSITY HOSPITAL	FC50, TH62, Sun Shading Profiles
ÇORLU INDUSTRY AND TRADE OFFICE	FC50
GOLDEN LIFE ÇORLU	LS60
DANIŞ TOWER ÇORLU	FC50
KEŞAN SARAL CITY	FC50
VENEZIA PROJECT	TH62 Hidden Vent, Standard and Custom design railing profiles
AYAZMA PROJECT / Custom design profiles,	TH55 , FC50
VAHDETTİN KÖŞKÜ (Presidential)	FDT62
AKTAR YAPI VİLLA	Glass Railing system
BEYLİKDÜZÜ WEST SİDE PROJECT	Square Railing profiles, Composite Panel
MİLENYUM KONAKLARI	Pergola system
MAXIMOON PROJECT	AS55, Composite Panel
SEA PEARL PROJECT-ATAKÖY	Glass Railing system
ACIBADEM HOSPITALS	Interior Partition and Indoor systems
EDİRNE SWIMMING POOL	FC50 , TH62, C55
KIPTAŞ MALTEPE EVLA PROJECT	Railing profiles, C55 , TH55
KIPTAŞ ÇATALCA KONUTLARI	FC50 , C55 , TH55
KIPTAŞ VADİTEPE BAHÇEŞEHİR	Küpeşte profilleri
SİNPAŞ ALTINORAN	Custom design Railing and windowsill profiles
SİNPAŞ AQUACITY DENİZLİ	Windowsill profiles
AĞAOĞLU MASLAK 1453	Railing profiles
KULLAR İNŞAAT HARAMİDERE HEAD OFFICE	FC50, TH62
AKRONES TERMAL OTEL-AFYON	Railing profiles, C55 , TH55
ÇİMSA – AFYON SOSYAL TESİSİ	TH62
AYDIN UNIVERSITY ADDITIONAL BUILDING	FC50, Interior Partition system
İTÜ MASLAK YURT KONUTLARI	Square Railing profiles
KURTKÖY ADATIP HOSPITAL	Custom design profiles, FC50
MERİT ROYAL KIBRIS	
PANAMA OTEL PROJECT	

AĞAOĞLU MASLAK 1453 / Sarıyer



TUAL ADALAR / Kartal



ÇORLU TİCARET VE SANAYİ ODASI / Tekirdağ



TUAL ADALAR / Kartal



SINPAŞ AQUACITY / Denizi



KIPTAŞ EVLA / Maltepe



VENEZIA MEGA / Gaziosmanpaşa



VENEZIA MEGA / Gaziosmanpaşa

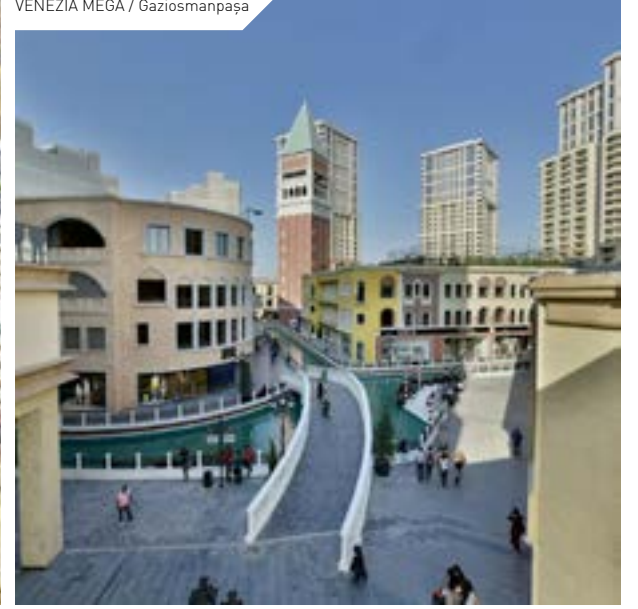

OTEL / Panama



MERIT ROYAL / Kıbrıs



ISPARTAKULE EVLERİ / Bahçeşehir



ISPARTAKULE EVLERİ / Bahçeşehir



VADİTEPE / Bahçeşehir



SARAL CITY / Keşan



ÇORLU GOLDEN LIFE / Tekirdağ



SINPAŞ ALTINORAN / Ankara



AKRONES TERMAL HOTEL / Afyon



NAMIK KEMAL ÜNİV. HATANESİ / Tekirdağ



AMASYA ÜNİVERSİTESİ



AS42

YALITIMSIZ KAPI-PENCERE SİSTEMİ COLD DOOR-WINDOW SYSTEM

Kasa Geniřliđi 42 mm
Frame Width

Kanat Geniřliđi 44 mm
Sash Width

Sistem Et Kalınlıđı 1.2 mm
Thickness

Cam Kalınlıđı 4-24 mm
Glazing

Aksesuar Seđimi Euro norm kanallı profiller. PVC aksesuarına uygun profiller (Multi Point Lock)
Groove Types Euro Norm groove PVC groove

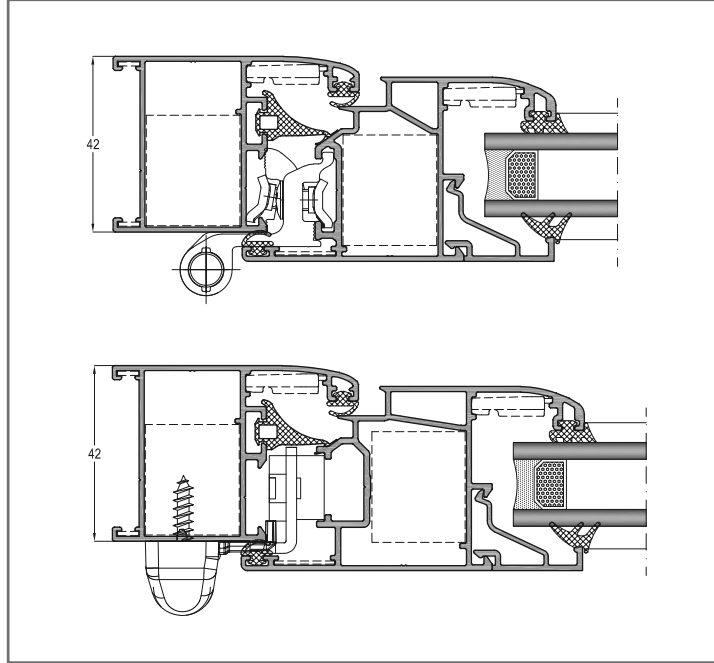
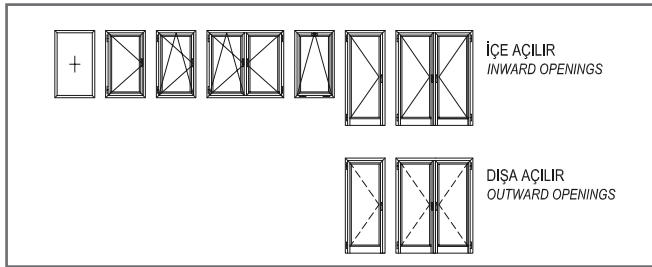

AS50

YALITIMSIZ KAPI-PENCERE SİSTEMİ COLD DOOR-WINDOW SYSTEM

Kasa Geniřliđi 50 mm (Oval ve döz kasa seđeneđi)
Frame Width

Kanat Geniřliđi 58 mm
Sash Width

Sistem Et Kalınlıđı 1.4 mm
Thickness

Cam Kalınlıđı 4-32 mm
Glazing

Aksesuar Seđimi Euro norm kanallı profiller. PVC aksesuarına uygun profiller (Multi Point Lock)
Groove Types Euro Norm groove PVC groove

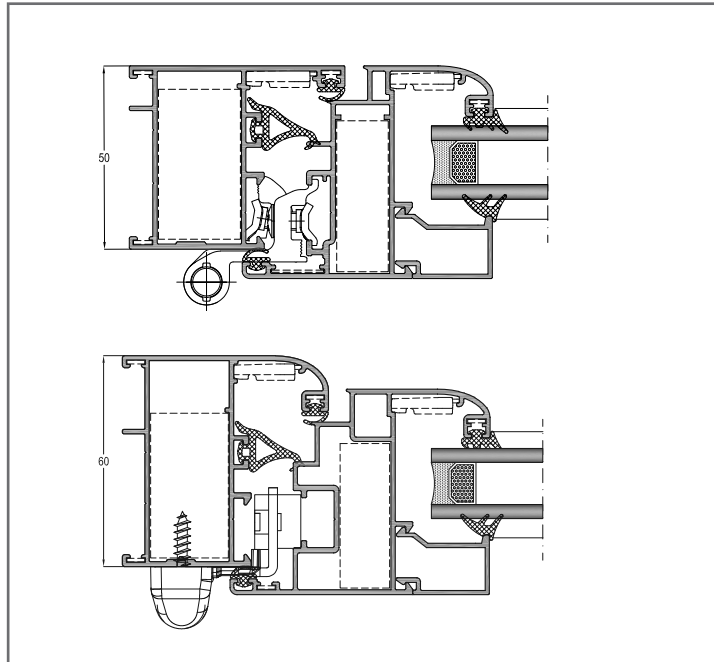
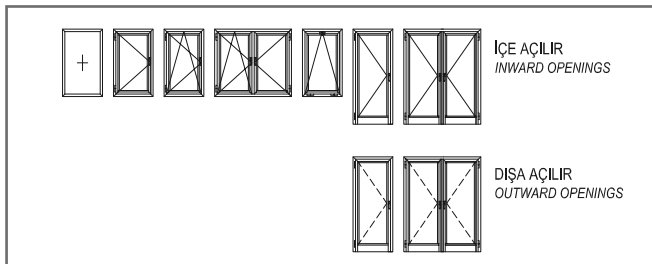

C55

YALITIMSIZ KAPI-PENCERE SİSTEMİ COLD DOOR-WINDOW SYSTEM

Kasa Geniřliđi 55 mm
Frame Width

Kanat Geniřliđi 58 mm
Sash Width

Sistem Et Kalınlıđı 1.8 mm
Thickness

Cam Kalınlıđı 4-40 mm
Glazing

Aksesuar Seçimi Euro norm kanallı profiller
Groove Types Euro Norm groove PVC groove

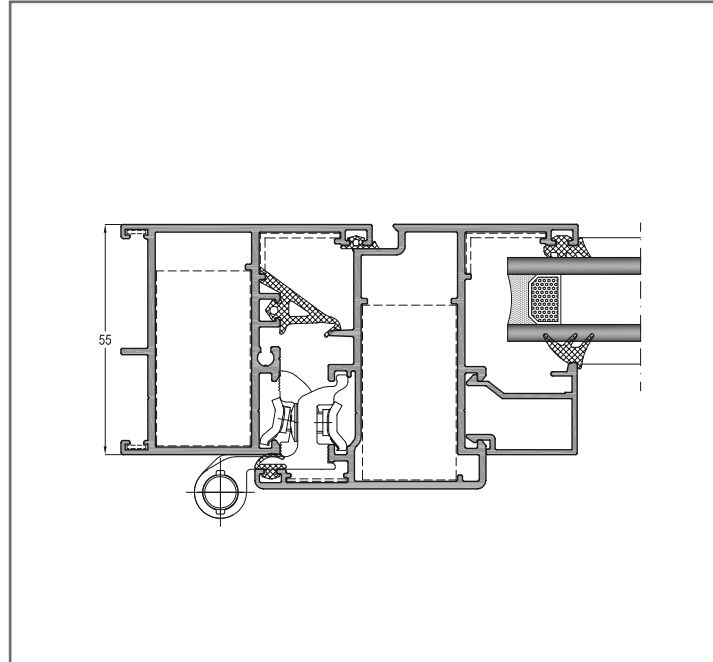
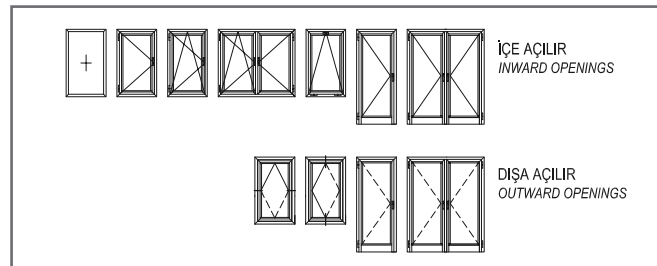

C60

YALITIMSIZ KAPI-VİTRİN SİSTEMİ COLD DOOR SYSTEM

Kasa Geniřliđi 60 mm
Frame Width

Kanat Geniřliđi 60 mm
Sash Width

Sistem Et Kalınlıđı 1.5 mm
Thickness

Cam Kalınlıđı 4- 20 mm
Glazing

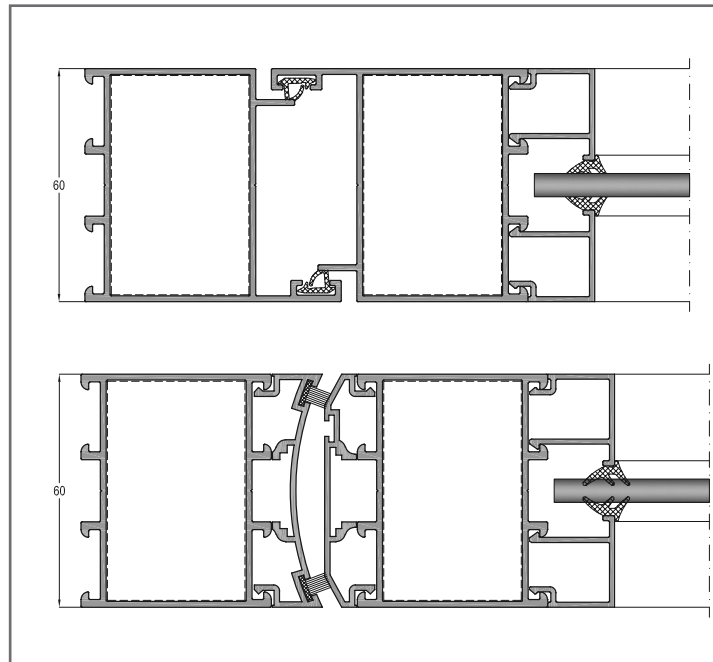
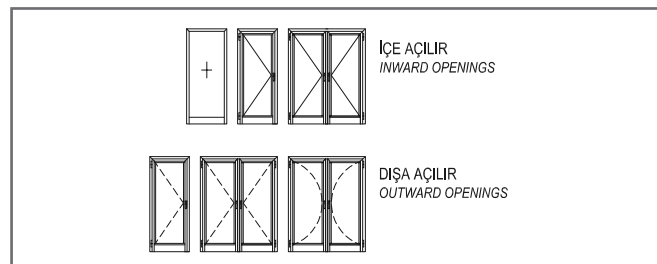

Estetik ve fonksiyonel...
Aesthetical and functional...



TE56

YALITIMLI KAPI-PENCERE SİSTEMİ THERMAL DOOR-WINDOW SYSTEM

Kasa Geniřliđi 56 mm
Frame Width

Kanat Geniřliđi 59 mm
Sash Width

Sistem Et Kalınlıđı 1.3 mm
Thickness

Isı Bariyeri 18 mm
Thermal Break

Cam Kalınlıđı 4-38 mm
Glazing

Isı Geçirgenlik Katsayısı $U_f=3,28 \text{ W/m}^2\text{K}$
Uf Value

Aksesuar Seçimi Euro norm kanallı profiller, PVC aksesuarına uygun profiller. (Multi Point Lock)
Groove Types Euro Norm groove. PVC groove.

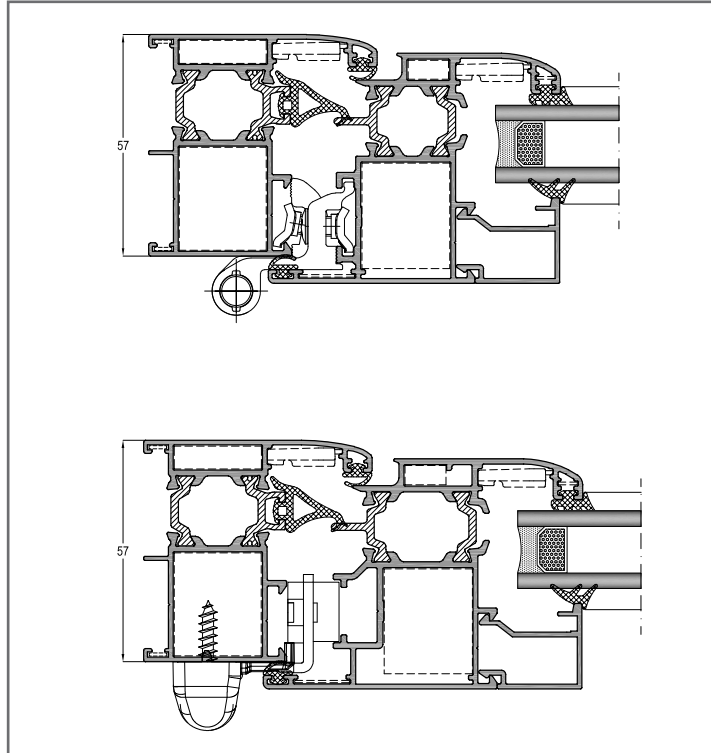
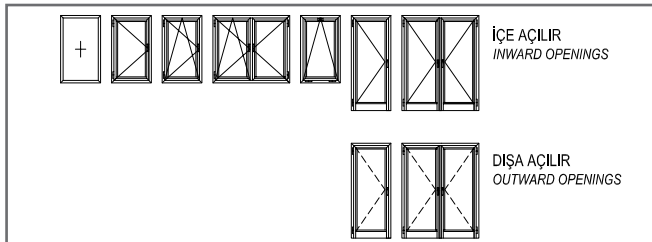

TE62

YALITIMLI KAPI-PENCERE SİSTEMİ THERMAL DOOR-WINDOW SYSTEM

Kasa Geniřliđi 62 mm
Frame Width

Kanat Geniřliđi 65 mm
Sash Width

Sistem Et Kalınlıđı 1.3 mm
Thickness

Isı Bariyeri 24 mm
Thermal Break

Cam Kalınlıđı 10-45 mm
Glazing

Isı Geçirgenlik Katsayısı $U_f=2,90 \text{ W/m}^2\text{K}$
Uf Value

Aksesuar Seçimi Euro norm kanallı profiller, PVC aksesuarına uygun profiller (Multi Point Lock)
Groove Types Euro Norm groove. PVC groove.

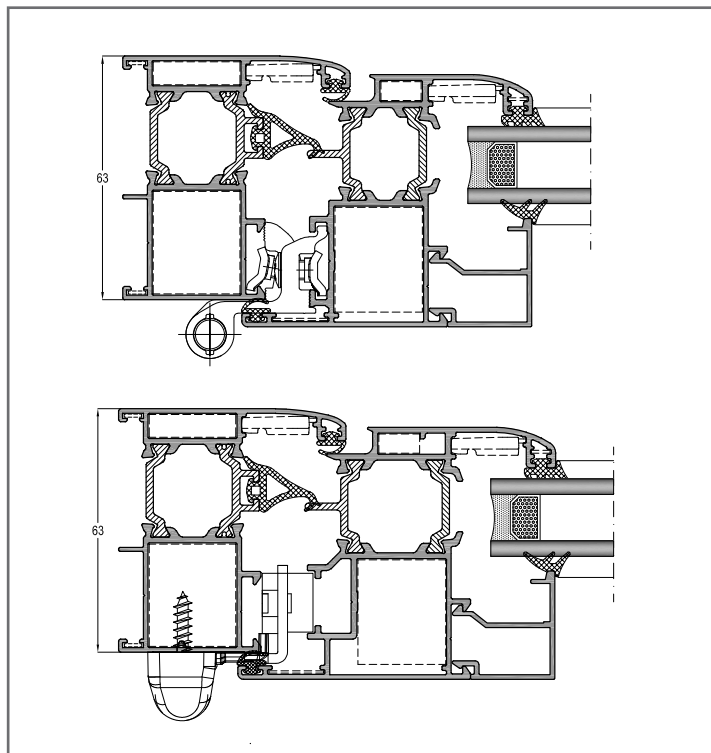
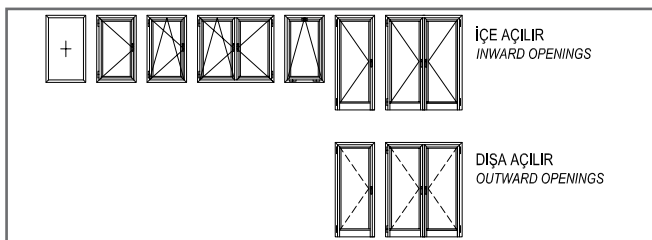



Her ihtiyaca uygun mimari çözümler...
Architectural solutions, which suit every need...

TH55

YALITIMLI KAPI-PENCERE SİSTEMİ THERMAL DOOR-WINDOW SYSTEM

Kasa Geniřliđi 55 mm
Frame Width

Kanat Geniřliđi 59 mm
Sash Width

Sistem Et Kalınlıđı 1.8 mm
Thickness

Isı Bariyeri 14.8 mm
Thermal Break

Cam Kalınlıđı 4-40 mm
Glazing

Isı Geçirgenlik Katsayısı $U_f = 3,25 \text{ W/m}^2\text{K}$
Uf Value

Aksesuar Seçimi Euro norm kanallı profiller. PVC aksesuarına uygun profiller (Multi Point Lock)
Groove Types Euro Norm groove. PVC groove.

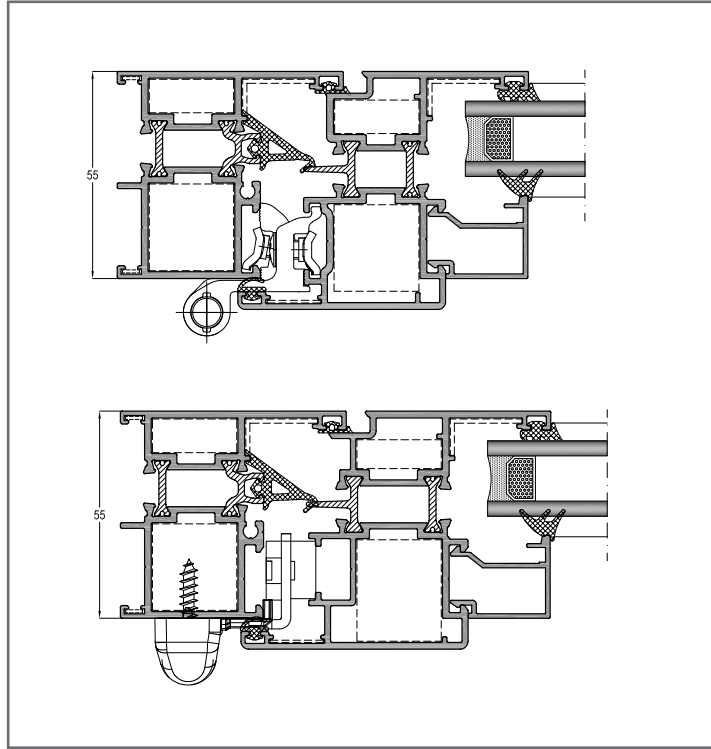
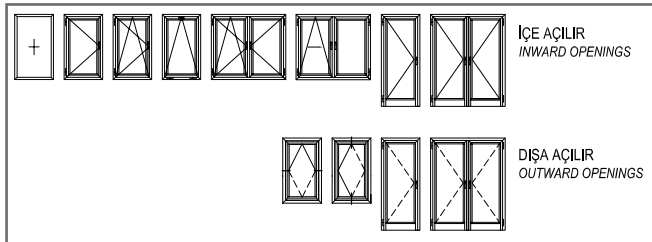

TM55

YALITIMLI KAPI-PENCERE SİSTEMİ THERMAL DOOR-WINDOW SYSTEM

Kasa Geniřliđi 55 mm
Frame Width

Kanat Geniřliđi 59 mm
Sash Width

Sistem Et Kalınlıđı 1.6 mm – 2 mm
Thickness

Isı Bariyeri 14.8 mm
Thermal Break

Cam Kalınlıđı 4-40 mm
Glazing

Isı Geçirgenlik Katsayısı $U_f = 3,29 \text{ W/m}^2\text{K}$
Uf Value

Aksesuar Seçimi Euro norm kanallı profiller. PVC aksesuarına uygun profiller (Multi Point Lock)
Groove Types Euro Norm groove. PVC groove.

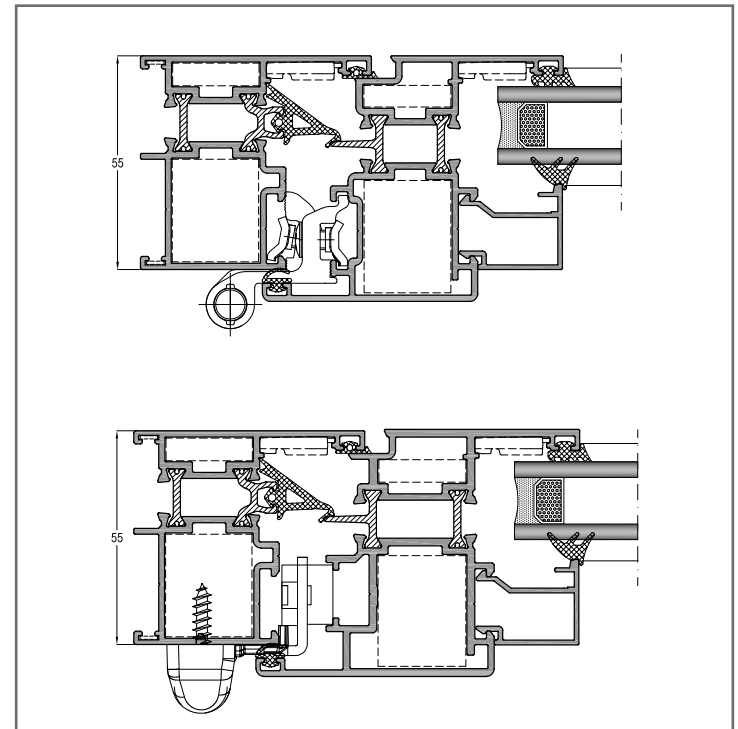
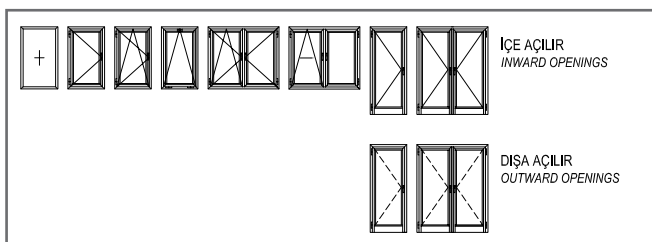

TH62

YALITIMLI KAPI-PENCERE SİSTEMİ THERMAL DOOR-WINDOW SYSTEM

Kasa Geniřliđi Frame Width	62 mm
Kanat Geniřliđi Sash Width	65 mm
Sistem Et Kalınlıđı Thickness	1.8 mm
Isı Bariyeri Thermal Break	18 mm
Cam Kalınlıđı Glazing	10-45 mm
Isı Geçirgenlik Katsayısı Uf Value	Uf=2,71 W/m ² K

Aksesuar Seçimi
Groove Types

Euro norm kanallı profiller. PVC aksesuarına uygun profiller (Multi Point Lock)
Euro Norm groove. PVC groove.

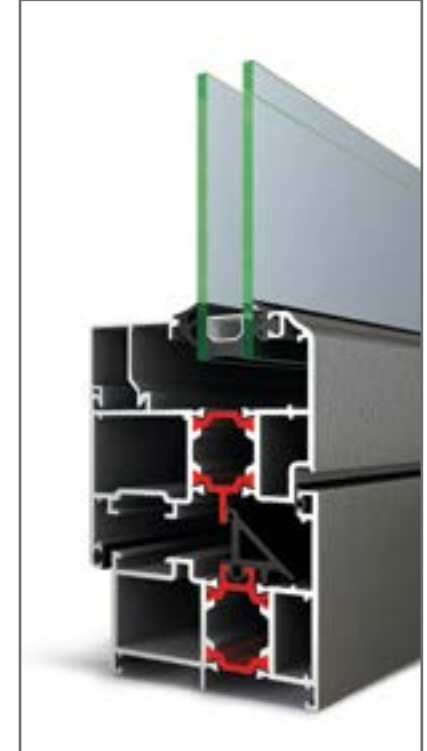
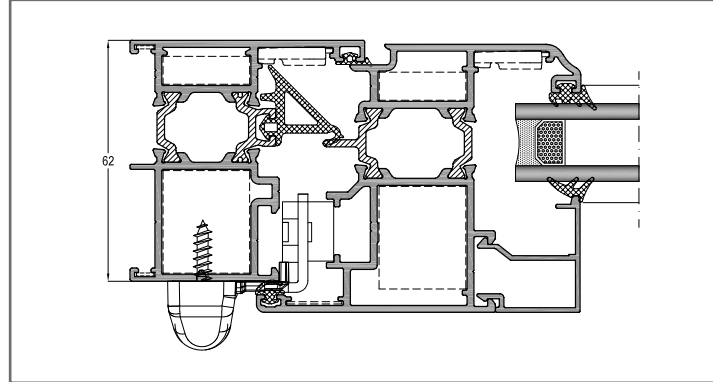
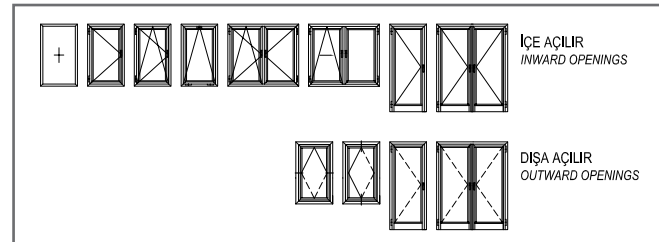

THS62

YALITIMLI KAPI-PENCERE SİSTEMİ THERMAL DOOR-WINDOW SYSTEM

Kasa Geniřliđi Frame Width	62 mm
Kanat Geniřliđi Sash Width	65 mm
Sistem Et Kalınlıđı Thickness	1.8 mm
Isı Bariyeri Thermal Break	18 mm
Cam Kalınlıđı Glazing	10-45 mm
Isı Geçirgenlik Katsayısı Uf Value	Uf=2,71 W/m ² K

Aksesuar Seçimi
Groove Types

Euro norm kanallı profiller.
PVC aksesuarına uygun profiller (Multi Point Lock)
Euro Norm groove. PVC groove.

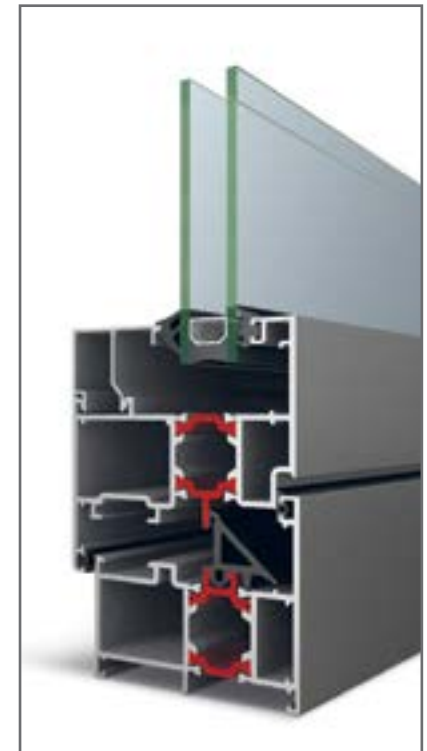
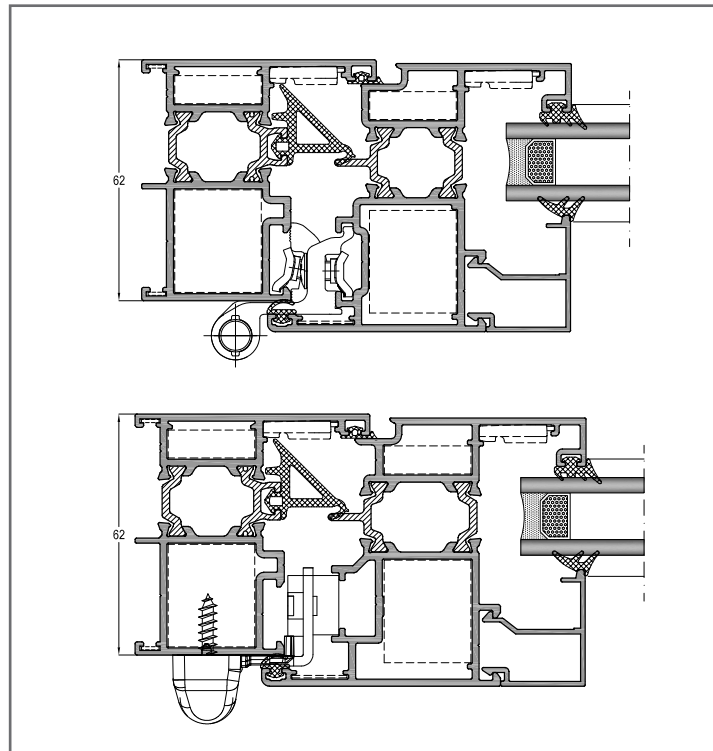
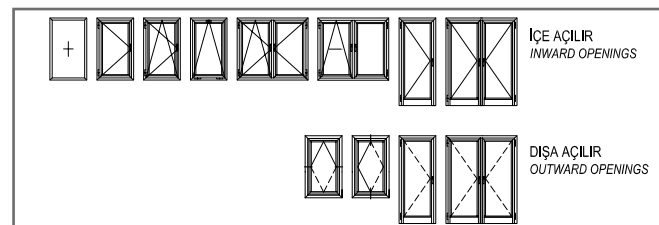

TH68

YALITIMLI KAPI-PENCERE SİSTEMİ THERMAL DOOR-WINDOW SYSTEM

Kasa Geniřliđi 68 mm
Frame Width

Kanat Geniřliđi 71 mm
Sash Width

Sistem Et Kalınlıđı 1.8 mm
Thickness

Isı Bariyeri 24 mm
Thermal Break

Cam Kalınlıđı 16-52 mm
Glazing

Isı Geçirgenlik Katsayısı $U_f = 2,52 \text{ W/m}^2\text{K}$
Uf Value

Aksesuar Seçimi Euro norm kanallı profiller. PVC aksesuarına uygun profiller (Multi Point Lock)
Groove Types Euro Norm groove. PVC groove.

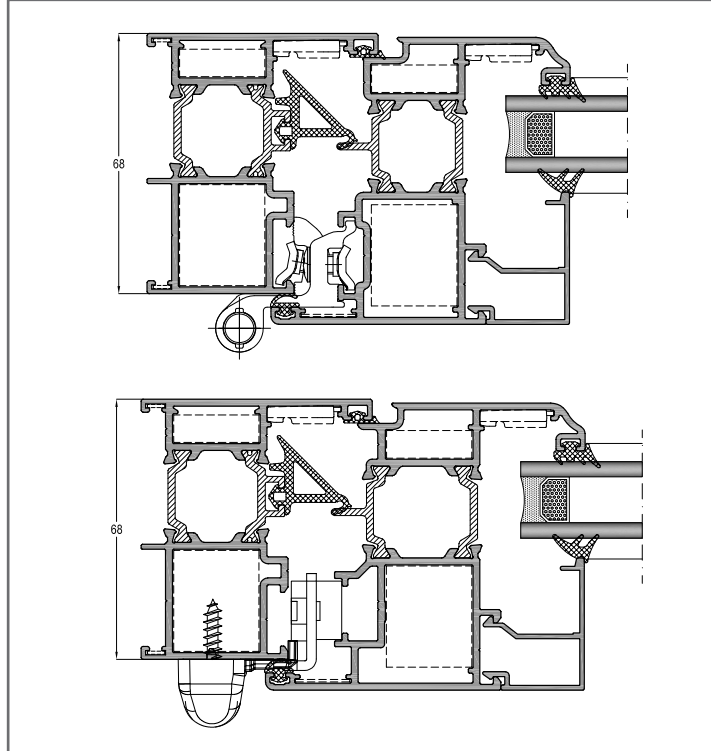
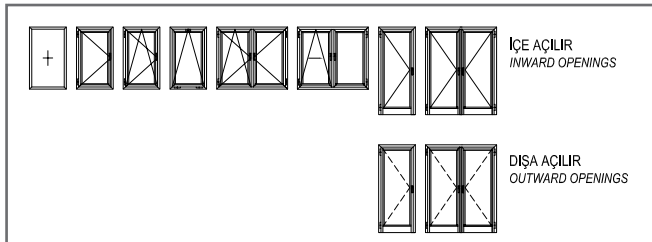

THS68

YALITIMLI KAPI-PENCERE SİSTEMİ THERMAL DOOR-WINDOW SYSTEM

Kasa Geniřliđi 68 mm
Frame Width

Kanat Geniřliđi 71 mm
Sash Width

Sistem Et Kalınlıđı 1.8 mm
Thickness

Isı Bariyeri 24 mm
Thermal Break

Cam Kalınlıđı 16-52 mm
Glazing

Isı Geçirgenlik Katsayısı $U_f = 2,52 \text{ W/m}^2\text{K}$
Uf Value

Aksesuar Seçimi Euro norm kanallı profiller. PVC aksesuarına uygun profiller (Multi Point Lock)
Groove Types Euro Norm groove. PVC groove.

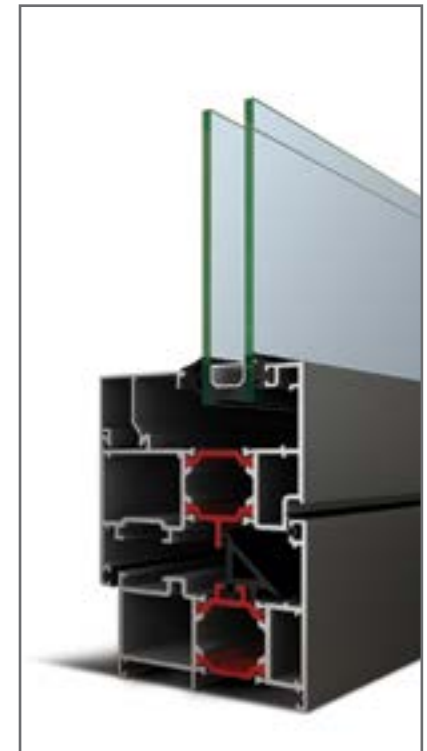
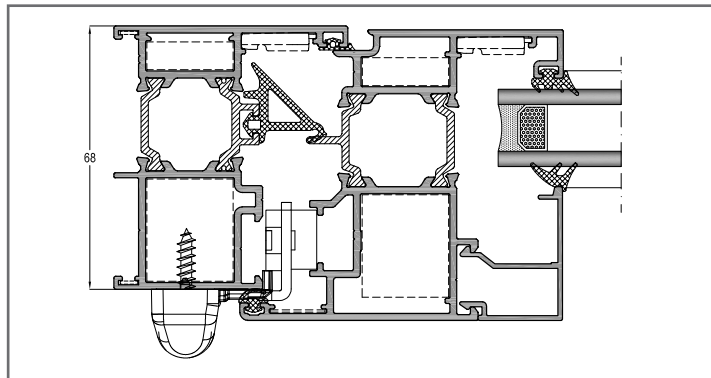
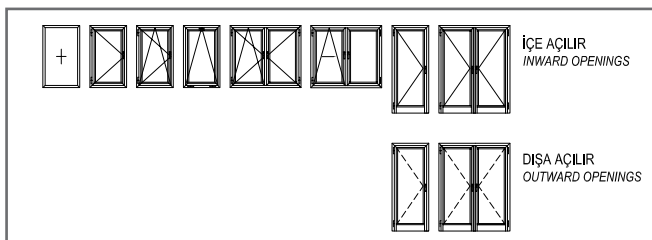

TH78

YALITIMLI KAPI-PENCERE SİSTEMİ THERMAL DOOR-WINDOW SYSTEM

Kasa Geniřliđi 78 mm
Frame Width

Kanat Geniřliđi 81 mm
Sash Width

Sistem Et Kalınlıđı 1.8 mm
Thickness

Isı Bariyeri 34 mm
Thermal Break

Cam Kalınlıđı 20-63 mm
Glazing

Isı Geçirgenlik Katsayısı $U_f=1,66 - 1,98 \text{ W/m}^2\text{K}$
Uf Value

Aksesuar Seçimi Euro norm kanallı profiller. PVC aksesuarına uygun profiller (Multi Point Lock)
Groove Types Euro Norm groove. PVC groove.

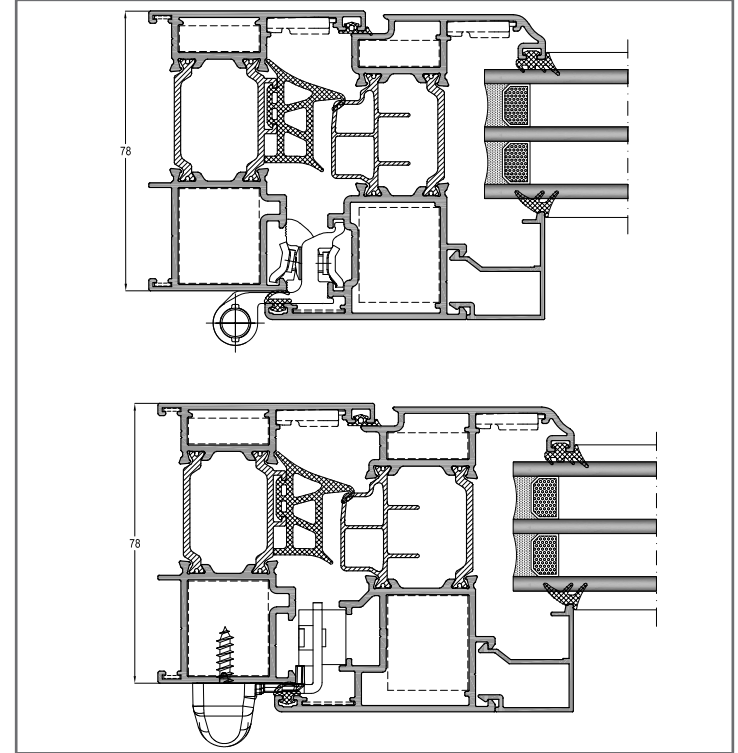
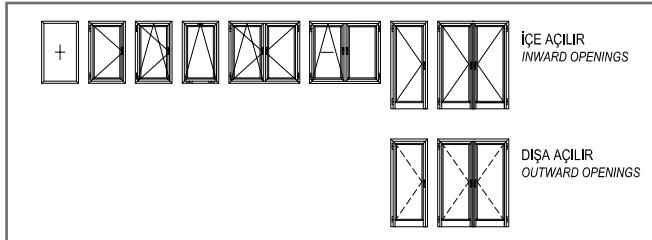

THS78

YALITIMLI KAPI-PENCERE SİSTEMİ THERMAL DOOR-WINDOW SYSTEM

Kasa Geniřliđi 78 mm
Frame Width

Kanat Geniřliđi 81 mm
Sash Width

Sistem Et Kalınlıđı 1.8 mm
Thickness

Isı Bariyeri 34 mm
Thermal Break

Cam Kalınlıđı 20-63 mm
Glazing

Isı Geçirgenlik Katsayısı $U_f=1,66 - 1,98 \text{ W/m}^2\text{K}$
Uf Value

Aksesuar Seçimi Euro norm kanallı profiller. PVC aksesuarına uygun profiller (Multi Point Lock)
Groove Types Euro Norm groove. PVC groove.

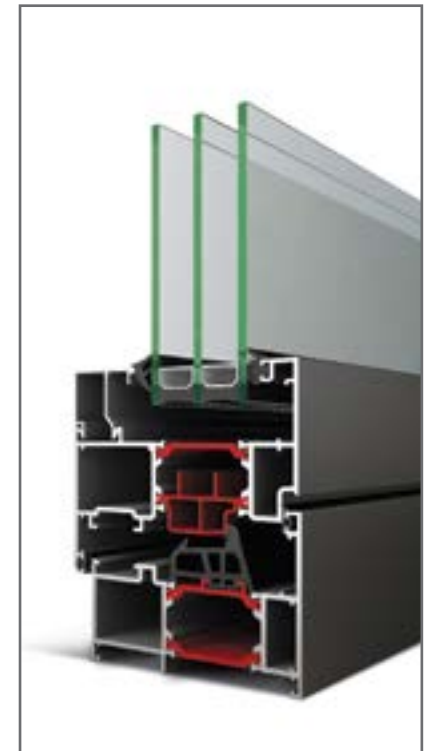
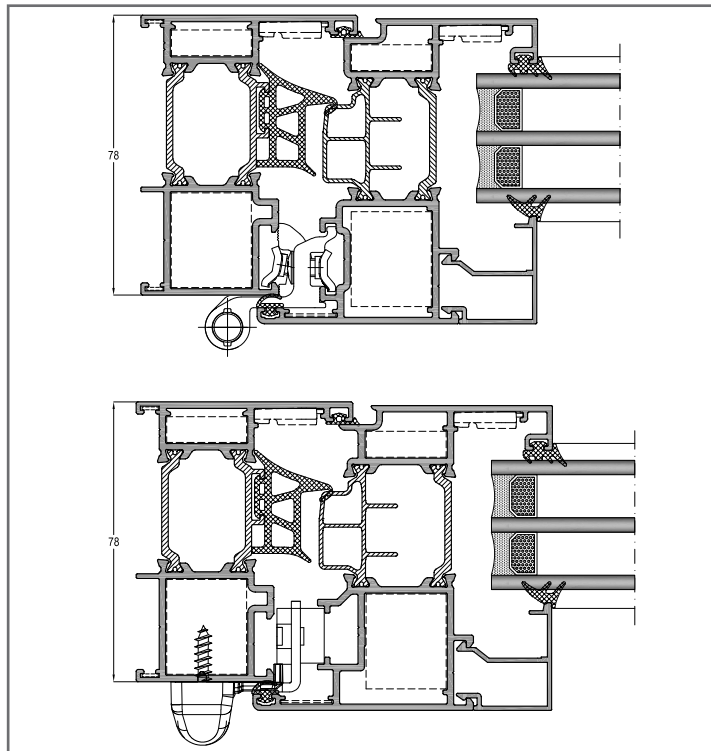
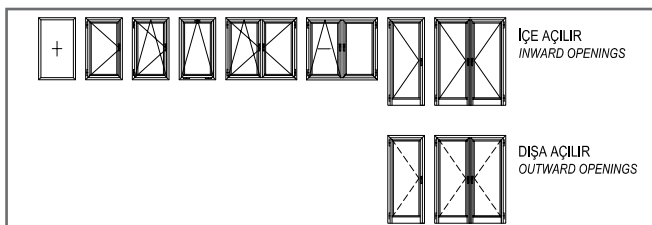

TH62-HV

YALITIMLI GİZLİ KANAT SİSTEMİ THERMAL HIDDEN-VENT SYSTEM

Kasa Geniřliđi 62 mm
Frame Width

Kanat Geniřliđi 65 mm
Sash Width

Sistem Et Kalınlıđı 1.8 mm
Thickness

Isı Bariyeri 18 mm
Thermal Break

Cam Kalınlıđı 24 mm
Glazing

Isı Geçirgenlik Katsayısı $U_f = 2,98 \text{ W/m}^2\text{K}$
Uf Value

Aksesuar Seçimi Euro norm kanallı profiller
Groove Types Euro Norm groove.

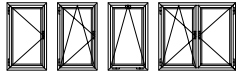

İÇE AÇILIR
INWARD OPENINGS

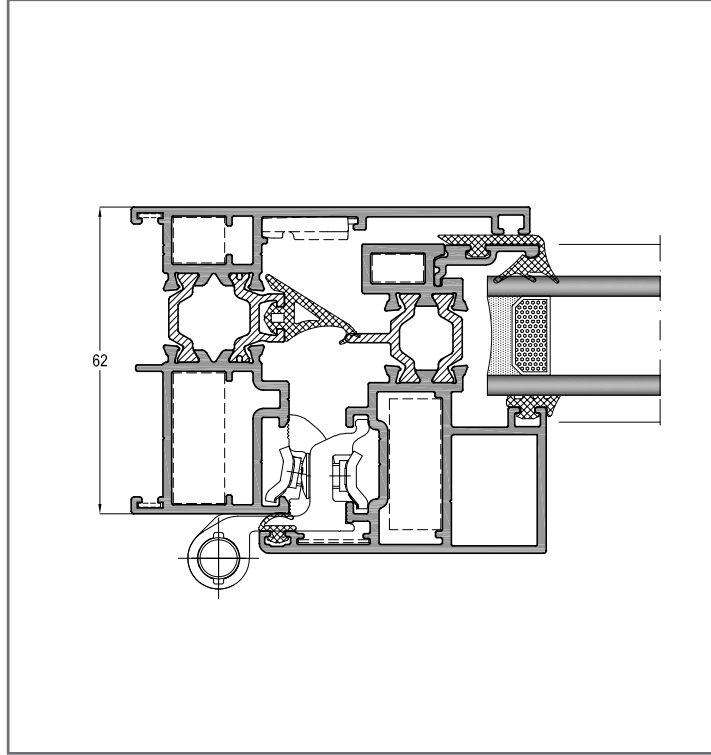

TH68-HV

YALITIMLI GİZLİ KANAT SİSTEMİ THERMAL HIDDEN-VENT SYSTEM

Kasa Geniřliđi 68 mm
Frame Width

Kanat Geniřliđi 71 mm
Sash Width

Sistem Et Kalınlıđı 1.8 mm
Thickness

Isı Bariyeri 24 mm
Thermal Break

Cam Kalınlıđı 30 mm
Glazing

Isı Geçirgenlik Katsayısı $U_f = 2,71 \text{ W/m}^2\text{K}$
Uf Value

Aksesuar Seçimi Euro norm kanallı profiller
Groove Types Euro Norm groove.

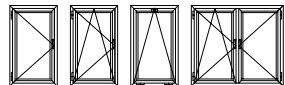

İÇE AÇILIR
INWARD OPENINGS

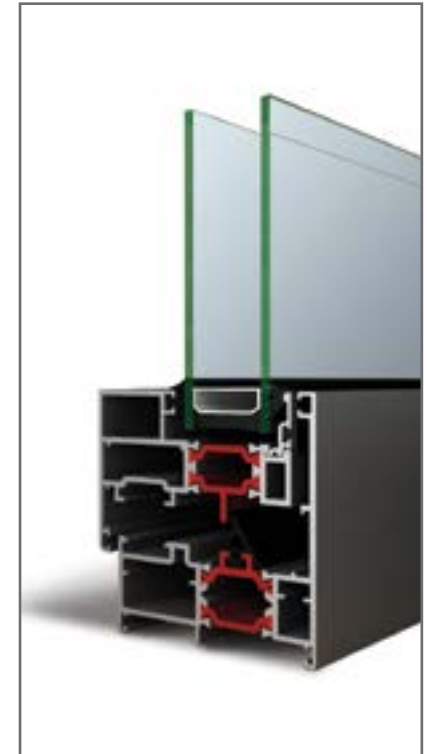
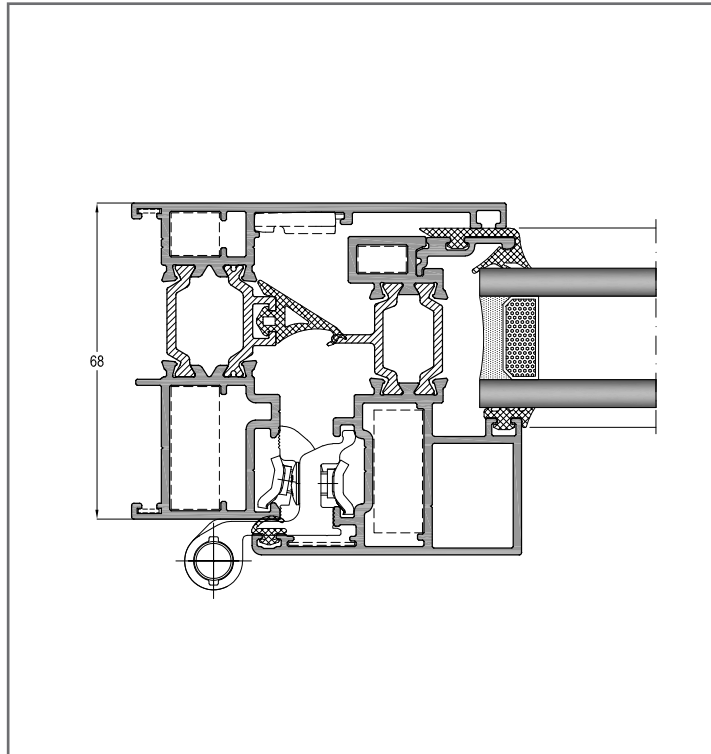

SL28

YALITIMSIZ SÜRME SİSTEM COLD SLIDING SYSTEM

Kasa Geniřliđi Frame Width	45mm - 76mm - 81mm
Kanat Geniřliđi Sash Width	28 mm - cam çıtasız kanat
Sistem Et Kalınlıđı Thickness	1.2 mm
Cam Kalınlıđı Glazing	4-22 mm
Açılım Tipleri Opening Types	İkili kanat, üçlü kanat, dördlü kanat, altılı kanat, sineklikli kanat 2, 3, 4 and 6 sliding sashes, flyscreen sash.

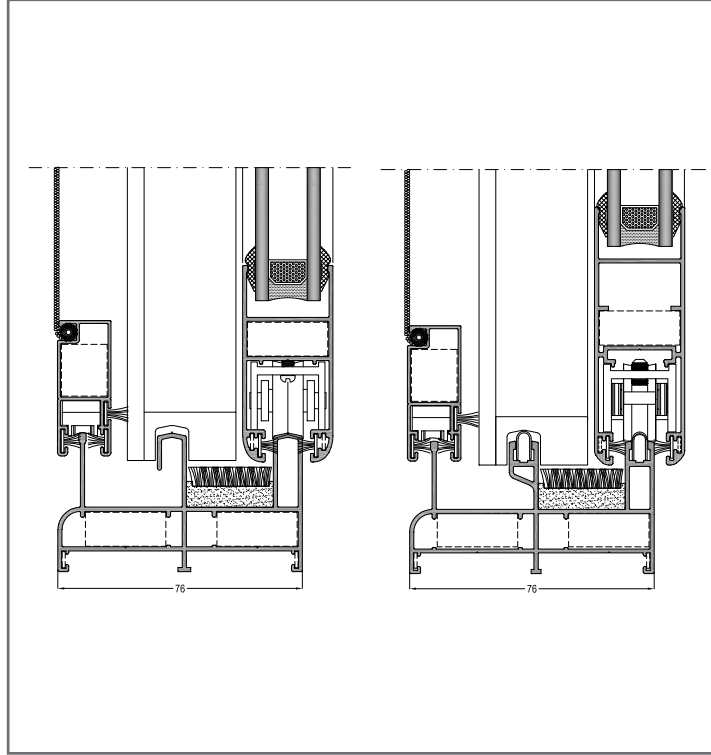
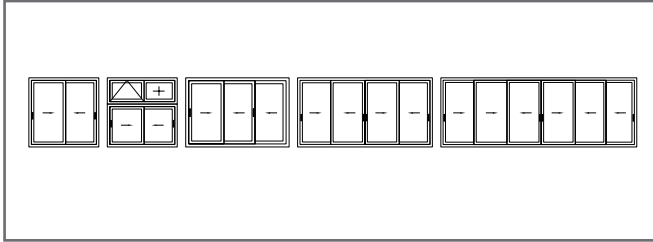

SL32

YALITIMSIZ SÜRME SİSTEM COLD SLIDING SYSTEM

Kasa Geniřliđi Frame Width	78mm - 100mm - 118mm
Kanat Geniřliđi Sash Width	32 mm - cam çıtasız ve cam çıtalı kanat
Sistem Et Kalınlıđı Thickness	1.4 mm
Cam Kalınlıđı Glazing	4, 5, 6, 8, 16, 18, 20, 22 mm
Açılım Tipleri Opening Types	İkili kanat, üçlü kanat, dördlü kanat, altılı kanat, sineklikli kanat 2, 3, 4 and 6 sliding sashes, flyscreen sash.

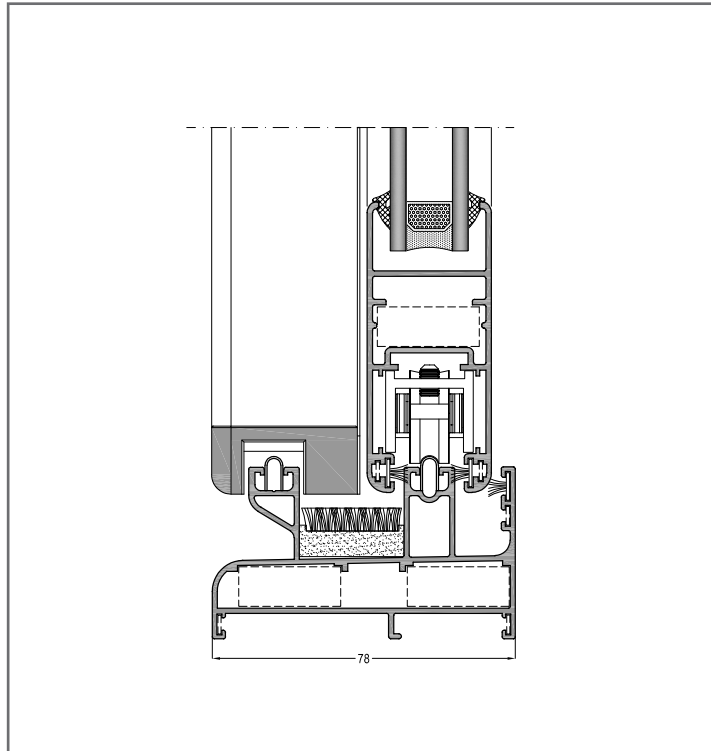
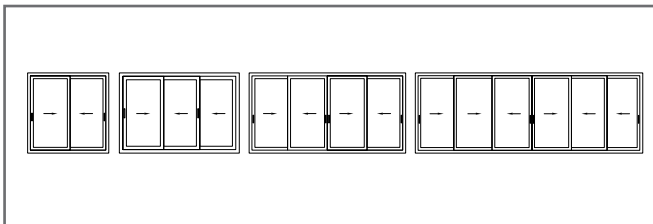

SL40

YALITIMSIZ SÜRME SİSTEM COLD SLIDING SYSTEM

Kasa Geniřliđi 79mm - 93mm - 115mm - 146mm
Frame Width

Kanat Geniřliđi 42 mm - cam ıtasız ve
ıtalı kanat
Sash Width

Sistem Et Kalınlıđı 1.4 mm
Thickness

Cam Kalınlıđı 4, 5, 6, 8, 16, 18, 20, 22 mm
Glazing

Aılım Tipleri İkili kanat, cl kanat, drtl
Opening Types kanat, altılı kanat, kendinden sabit
kanatlı kasa ile hareketli tek kanat,
sineklikli kanat
2, 3, 4 and 6 sliding sashes,
flyscreen sash, 1 sliding 1 fixed
sash frame.

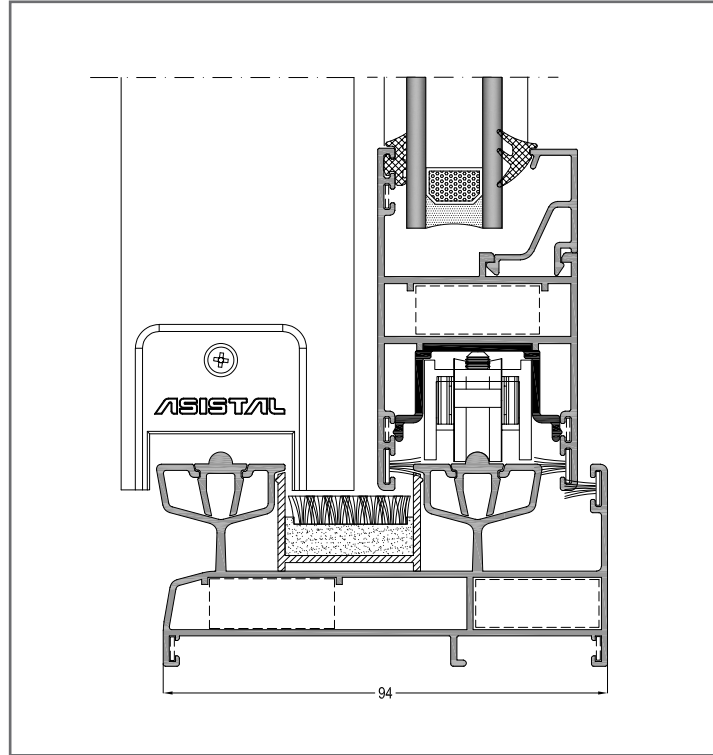
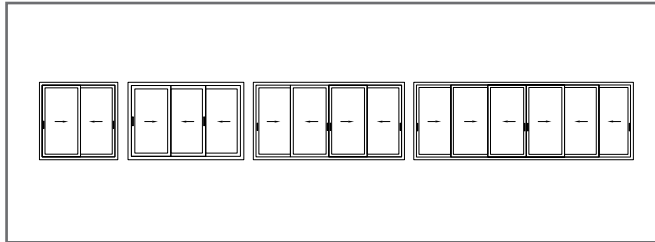

SL40T

YALITIMLI SÜRME SİSTEM THERMAL SLIDING SYSTEM

Kasa Geniřliđi 93mm - 115mm - 146mm
Frame Width

Kanat Geniřliđi 42 mm
Sash Width

Sistem Et Kalınlıđı 1.4 mm
Thickness

Isı Bariyeri Kasa-18mm, Kanat- 14,8mm
Thermal Break

Cam Kalınlıđı 4, 5, 6, 8, 16, 18, 20, 22 mm
Glazing

Aılım Tipleri İkili kanat, cl kanat, drtl
Opening Types kanat, altılı kanat, kendinden sabit
kanatlı kasa ile hareketli tek kanat,
sineklikli kanat
2, 3, 4 and 6 sliding sashes,
flyscreen sash, 1 sliding
1 fixed sash frame.

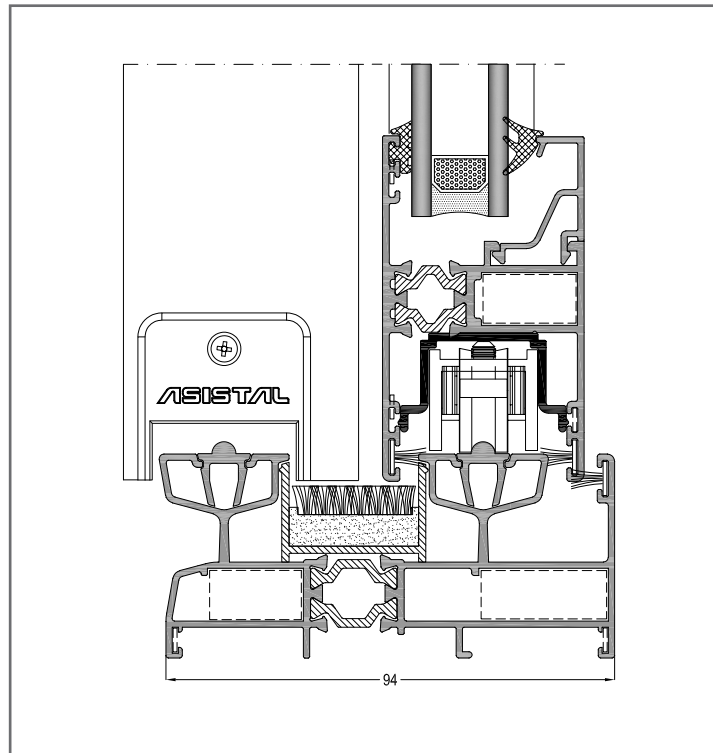
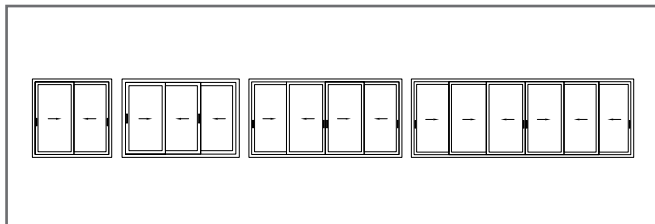

SL38T-K

YALITIMLI KALDIR & SÜR SİSTEM THERMAL LIFT & SLIDE SYSTEM

Kasa Geniřliđi Frame Width	87,5 mm, 94 mm, 107 mm
Kanat Geniřliđi Sash Width	38 mm Cam ıtasız ve cam ıtalı kanat
Sistem Et Kalınlıđı Thickness	1,4 mm
Isı Bariyeri Thermal Break	Kasa 24 mm, Kanat 20 mm
Cam Kalınlıđı Glazing	4, 5, 6, 8, 16, 20, 22, 24 mm
Kanat Tařıma Kapasitesi Sash Carry Capacity	200 kg
Max Kanat Eni Max Sash Width	650 mm - 2000 mm
Max Kanat Yksekliđi Max Sash Height	1200 mm - 2400 mm

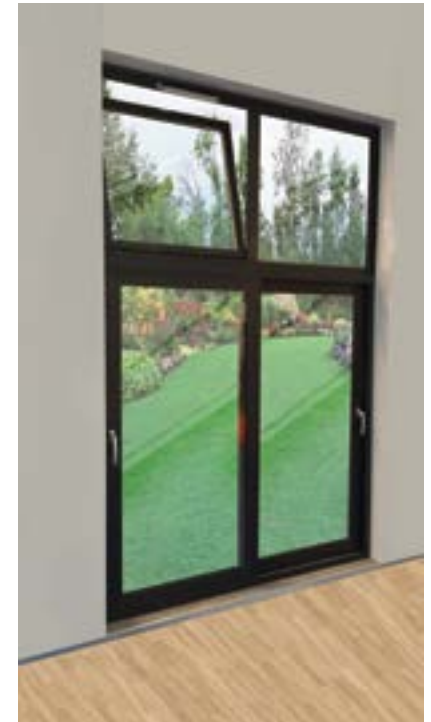
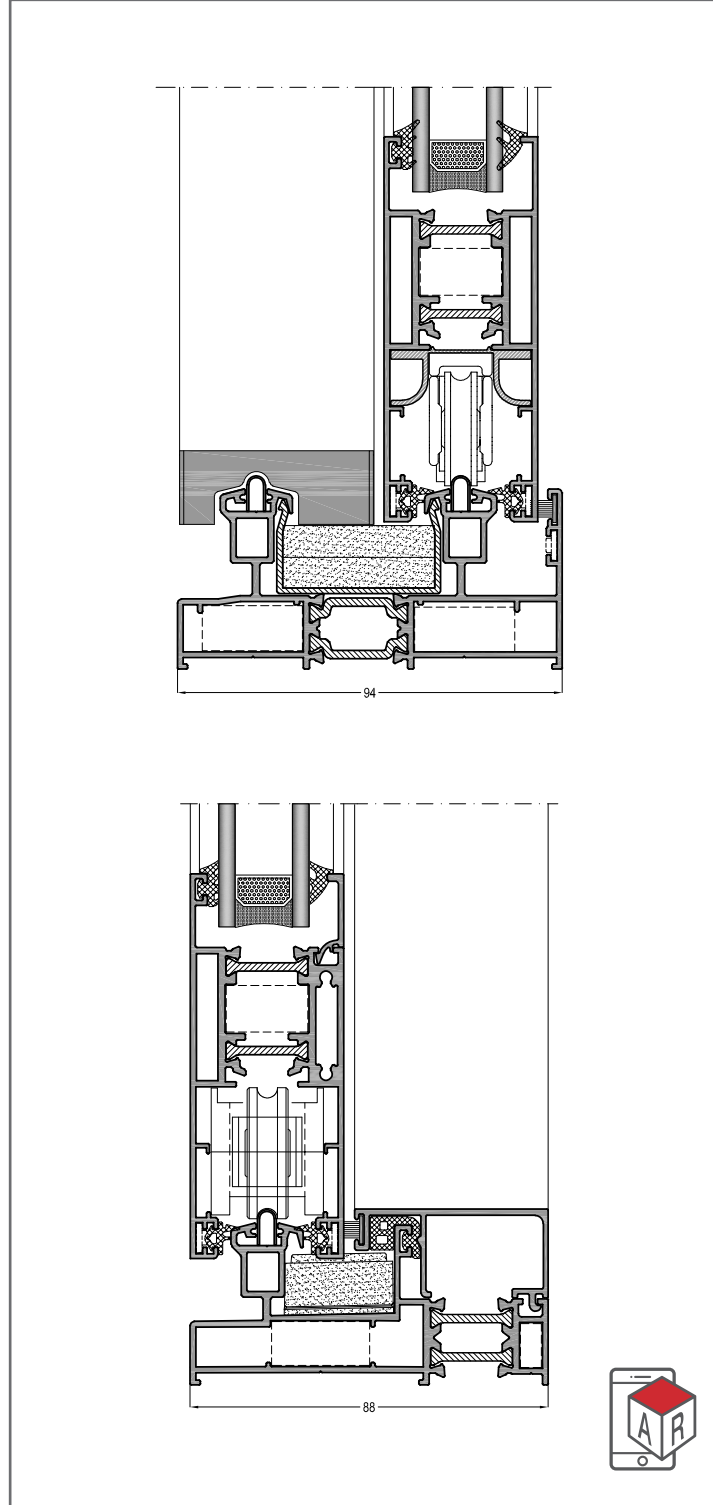
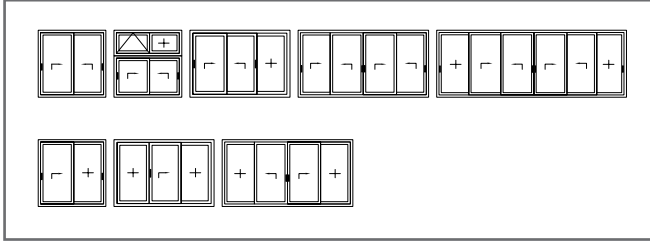

SL38T-N

YALITIMLI SÜRME SİSTEM

THERMAL SLIDING SYSTEM

Kasa Geniřliđi 87,5 mm - 94mm - 107mm - 144mm
Frame Width

Kanat Geniřliđi 38 mm - cam ıtasız
ve cam ıtalı kanat
Sash Width

Sistem Et Kalınlıđı 1.4 mm
Thickness

Isı Bariyeri Kasa-24mm, Kanat- 20mm
Thermal Break

Cam Kalınlıđı 4, 5, 6, 8, 16, 18, 20, 22, 24 mm
Glazing

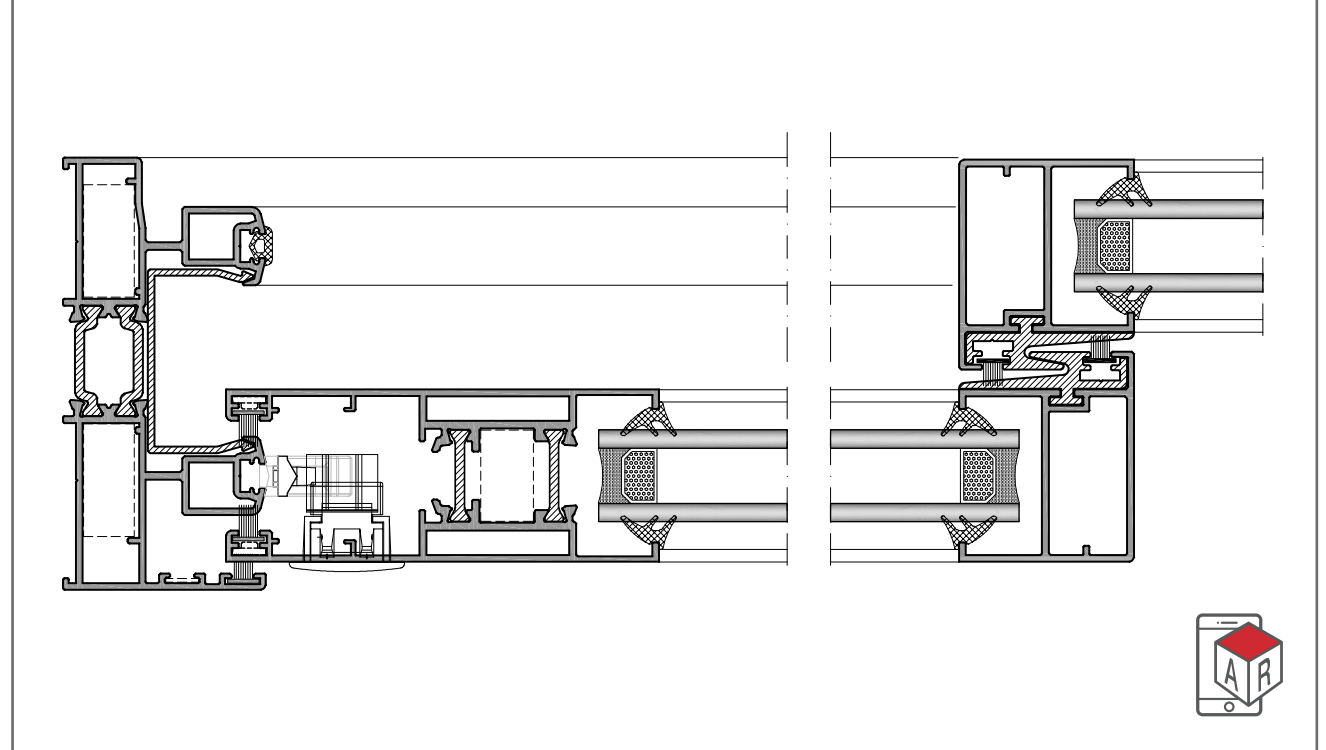
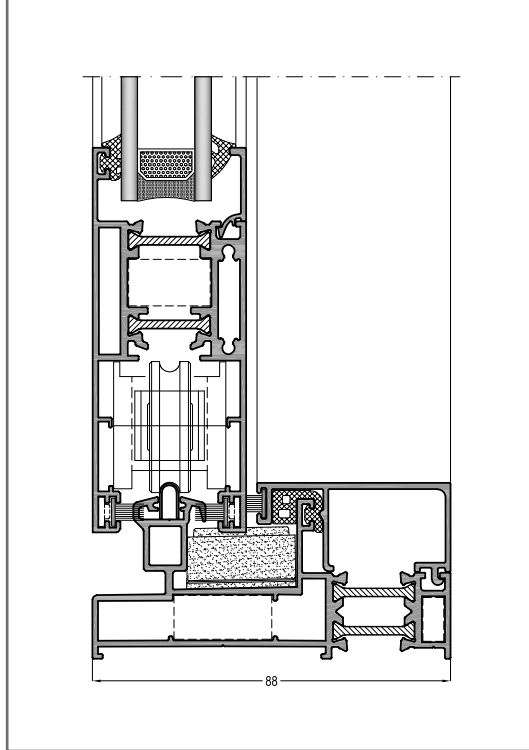
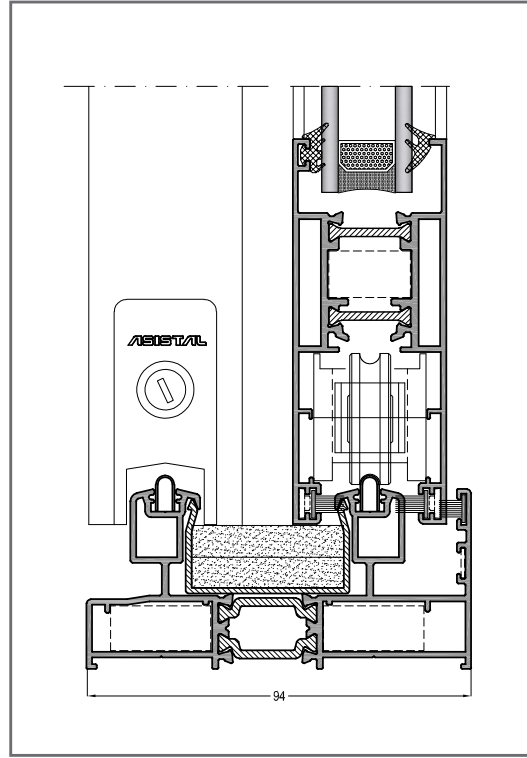
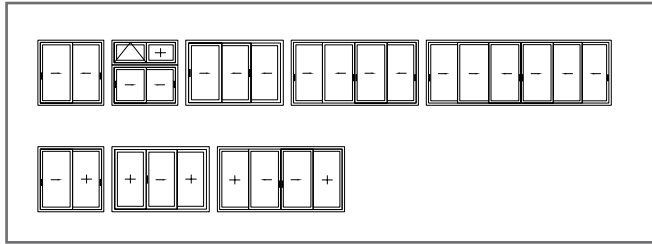



Kolay kullanım fonksiyonel çözüm...

Easy to use functional solution...

LS60-K

YALITIMLI KALDIR & SÜR SİSTEM THERMAL LIFT & SLIDE SYSTEM

Kasa Geniřliđi Frame Width	69mm - 136mm - 145mm - 221mm
Kanat Geniřliđi Sash Width	60 mm
Sistem Et Kalınlıđı Thickness	1.8 mm
Isı Bariyeri Thermal Break	Kasa-24mm, Kanat- 14,8mm
Cam Kalınlıđı Glazing	10 - 46 mm
Kanat Tařıma Kapasitesi Sash Carry Capacity	200 kg - 400 kg
Max Kanat Eni Max Sash Width	720 mm - 3235 mm
Max Kanat Yüklüklüđi Max Sash Height	1200 mm - 2700 mm ilave parça ile 3300 mm with additional part 3300 mm

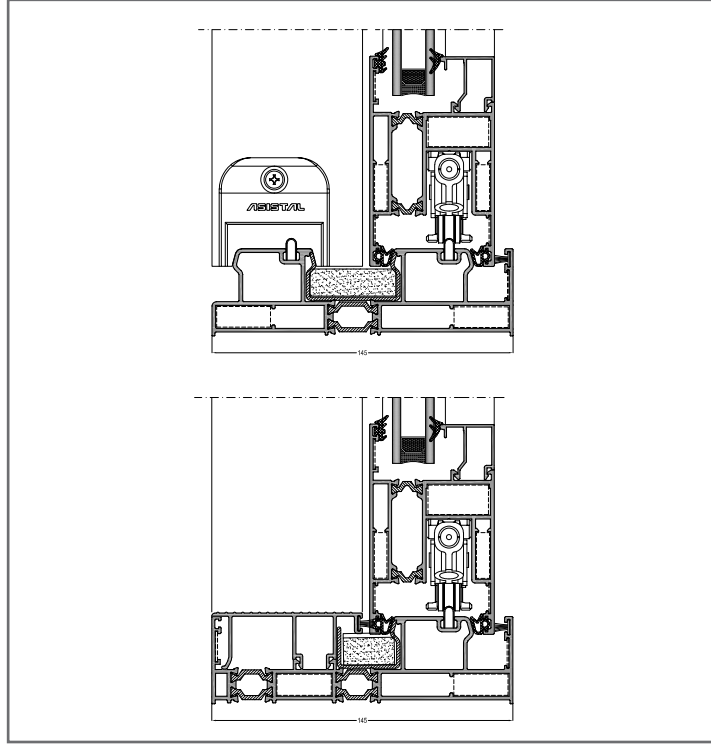
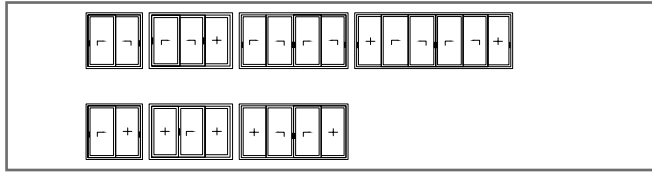

LS60-N

YALITIMLI SÜRME SİSTEM THERMAL SLIDING SYSTEM

Kasa Geniřliđi Frame Width	69mm - 136mm - 145mm - 221mm
Kanat Geniřliđi Sash Width	60 mm
Sistem Et Kalınlıđı Thickness	1.8 mm
Isı Bariyeri Thermal Break	Kasa-24mm, Kanat- 14,8mm
Cam Kalınlıđı Glazing	10 - 46 mm
Kanat Tařıma Kapasitesi Sash Carry Capacity	300 kg

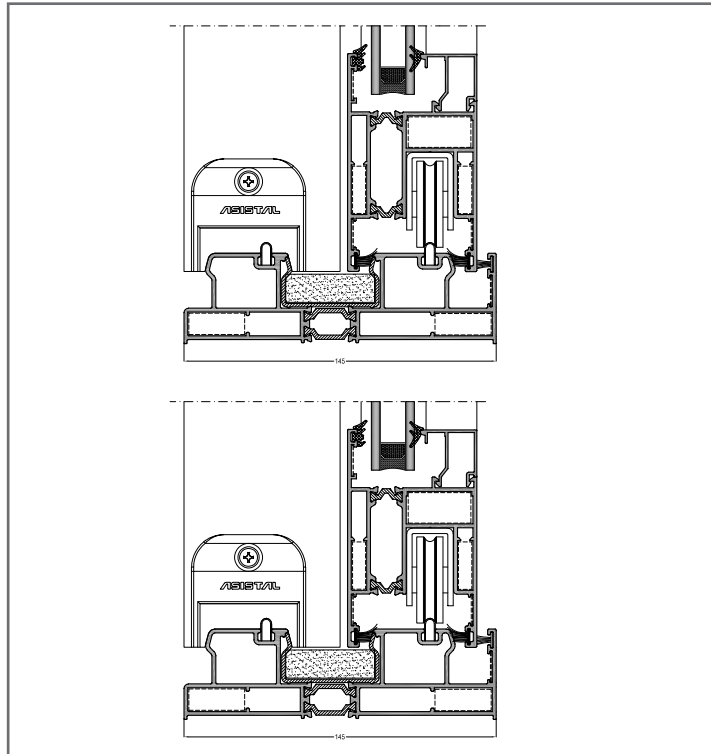
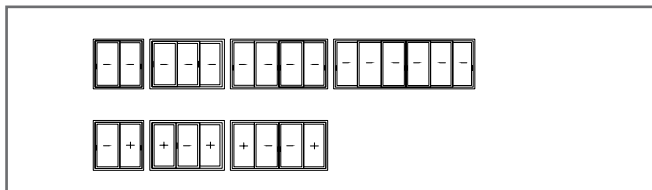

FDT62

YALITIMLI KATLANIR KAPI SİSTEMİ THERMAL FOLDING DOOR SYSTEM

Kasa Geniřliđi 62 mm
Frame Width

Kanat Geniřliđi 62 mm
Sash Width

Sistem Et Kalınlıđı 1.6 mm
Thickness

Isı Bariyeri 20 mm
Thermal Break

Cam Kalınlıđı 4-40 mm
Glazing

Aksesuar Seđimi Sisteme özel kol, kilitleme
Accessory Selection Special hinges, handles and locking

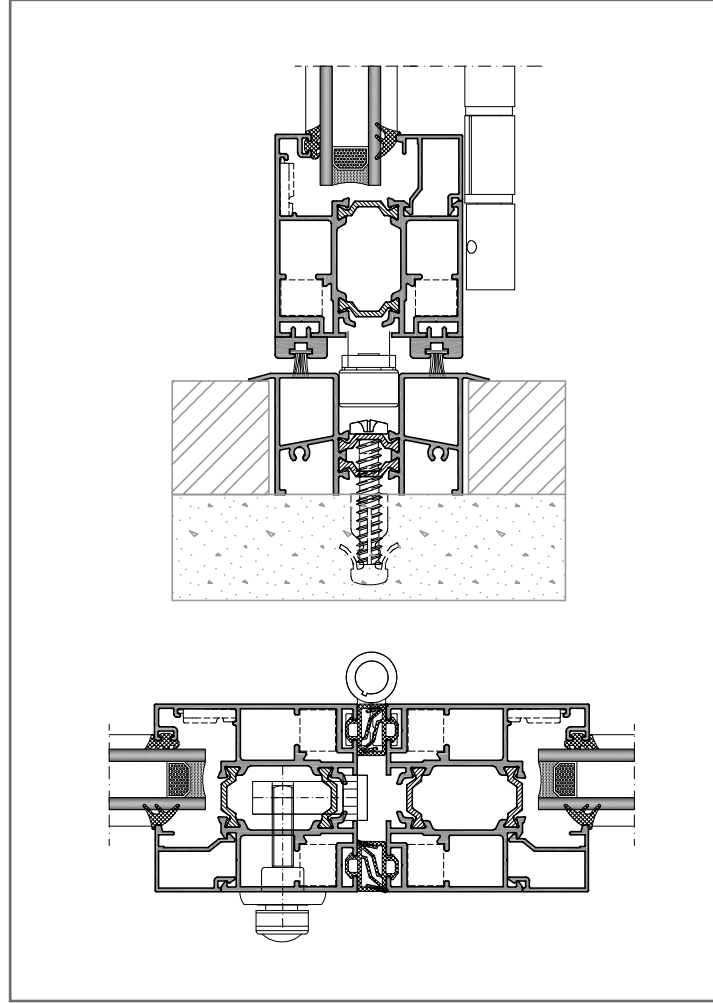
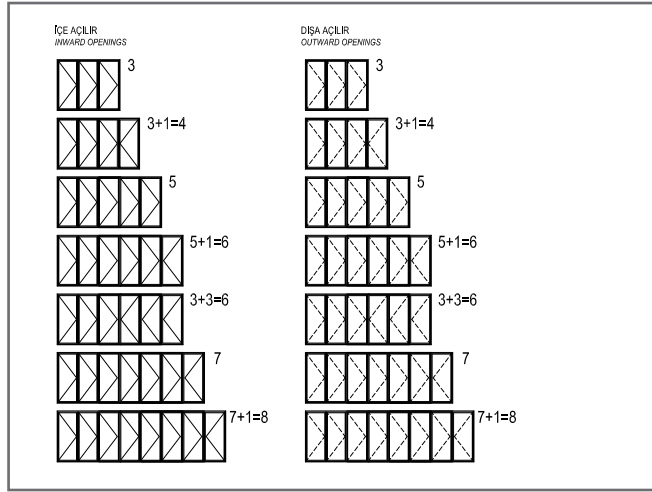



Projenize deęer katar...
It adds value to your project...

FC50-AS

CEPHE SİSTEMİ

CURTAIN WALL SYSTEM

Kondens kanallı cephe Sistemi

Curtain wall system with condense channel

Düsey Profiller 30, 50, 80, 90, 100, 120, 140,
Mullion Profiles 146, 150, 166, 188, 210 mm

Yatay Profiller 35, 50, 60, 65, 80, 105, 125, 155 mm
Transom Profiles

Sistem Et Kalınlığı 1.6mm, 1.9mm
Thickness

Cam Kalınlığı 6 mm - 52 mm
Glazing

Isı Geçirgenlik Katsayısı $U_f = \text{min } 2,13 \text{ W/m}^2\text{K}$ (cam kalınlıklarına bağlı /
Uf Value according to the glass thickness)

FC50-AS1 Kapaklı Cephe
Curtain wall

FC50-AS2 Yarı Kapaklı Cephe
Semi cover curtain wall

FC50-AS3 Kasetli Silikon Cephe
Structurel silicone

FC50-AS4 Ekonomik Silikon Cephe
Eco structurel silicone

FC50-AS5 Cam İçi Çıtalı Silikon Cephe
4 side structurel silicone

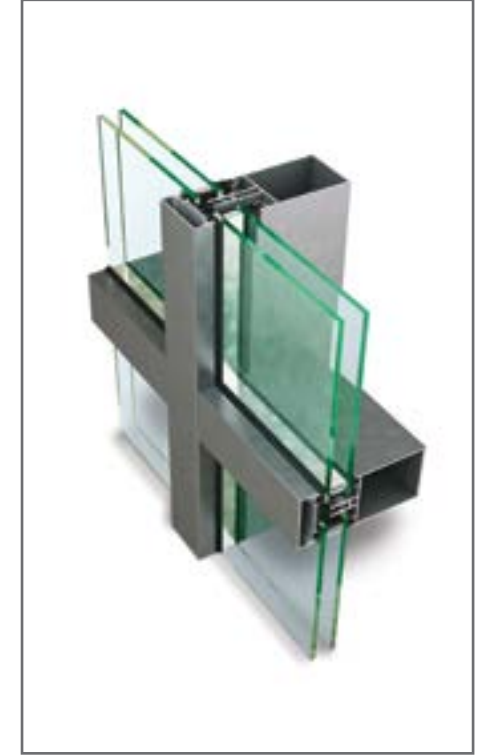
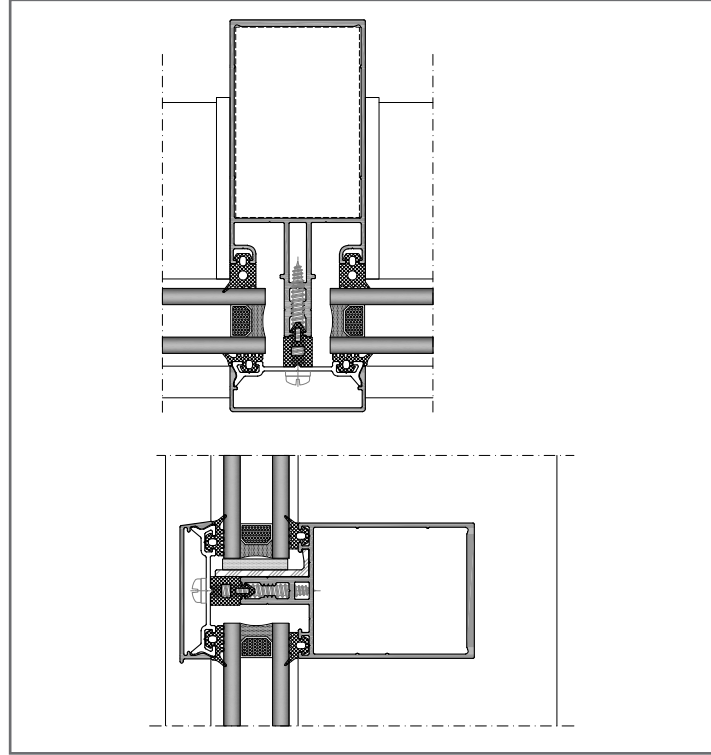

FC50-AS1 Kapaklı Cephe
Curtain wall

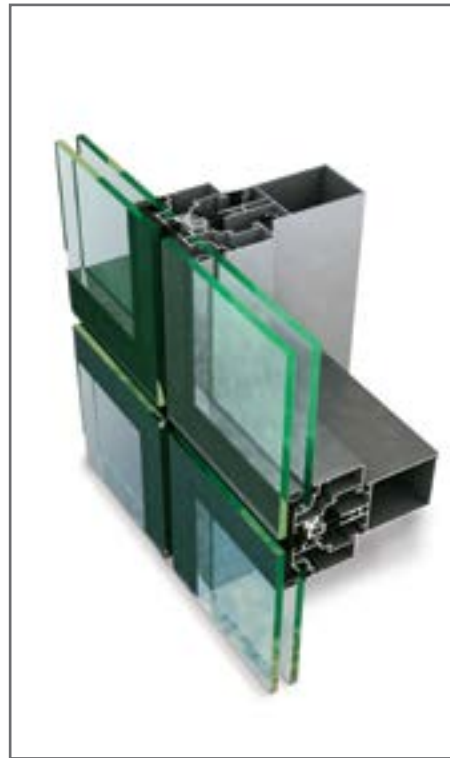

FC50-AS3 Kasetli Silikon Cephe
Structurel silicone

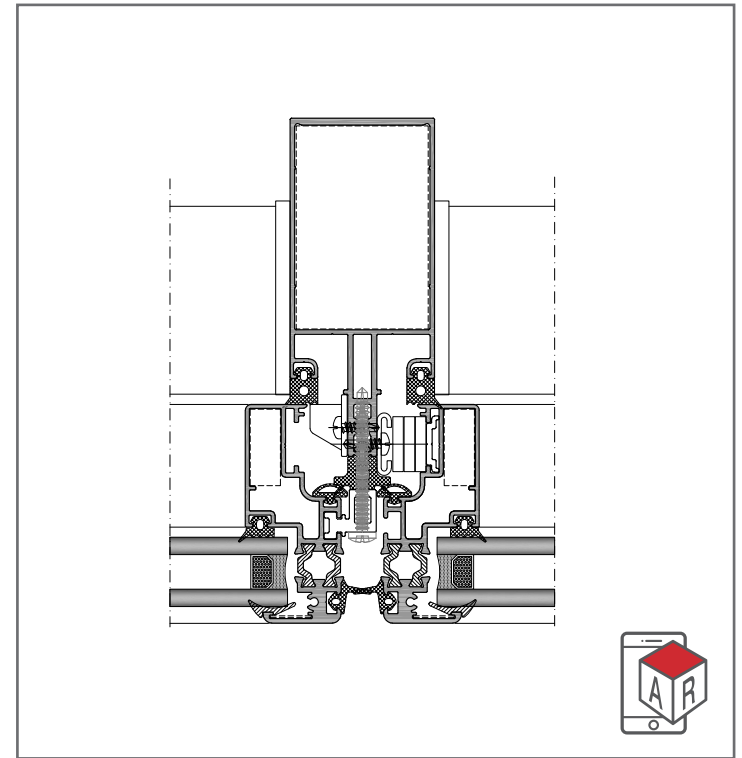

FC50-AST

CEPHE SİSTEMİ

CURTAIN WALL SYSTEM

Yatay ve düşey aynı profil kullanımı
Mullion and transom are same profiles

Düşey Profiller 35, 50, 60, 65, 80, 105, 125, 155mm
Mullion Profiles

Yatay Profiller 35, 50, 60, 65, 80, 105, 125, 155mm
Transom Profiles

Sistem Et Kalınlığı 1.6mm, 1.9mm
Thickness

Cam Kalınlığı 6 mm - 52 mm
Glazing

Isı Geçirgenlik Katsayısı $U_f = \min 1,94 \text{ W/m}^2\text{K}$ (cam kalınlıklarına bağlı /
according to the glass thickness)
Uf Value

FC50-AST1 Kapaklı Cephe
Curtain wall

FC50-AST2 Yarı Kapaklı Cephe
Semi cover curtain wall

FC50-AST3 Kasetli Silikon Cephe
Structural silicone

FC50-AST4 Cam İçi Çıtalı Silikon Cephe
4 side structural silicone.

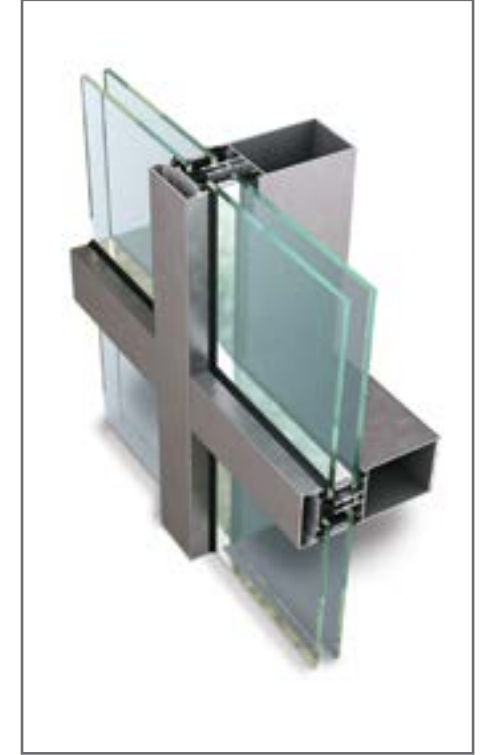
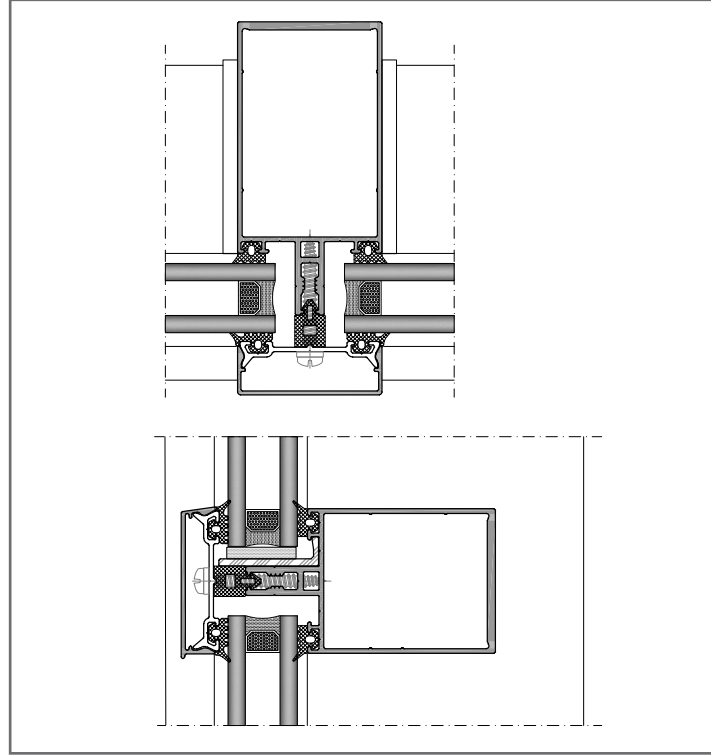

FC50-AST1 Kapaklı Cephe
Curtain wall

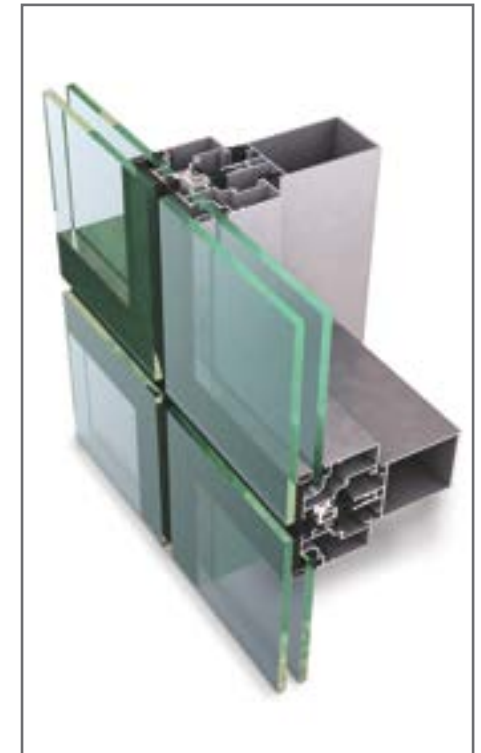
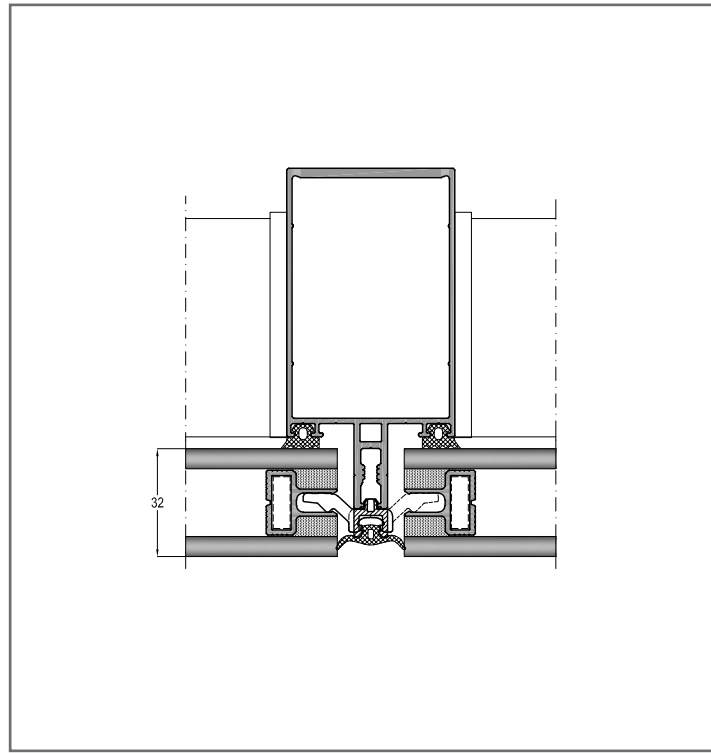

FC50-AST4 Cam İçi Çıtalı Silikon Cephe
32mm ve 40mm cam kullanımı
4 side structural silicone.
For 32mm and 40mm glass



Premium kalite herkesin hakkı...
Everyone deserves Premium quality...

INTERNO 85

ÇİFT CAMLI OFİS BÖLME SİSTEMİ DOUBLE GLAZING INTERIOR PARTITION SYSTEM

Sistem Kasa Geniřliđi 85 mm
Frame Width

Aħsap Panel Kalınlıđı 18 mm
Wood Panelthickness

Cam Kalınlıđı 5 mm
Glazing

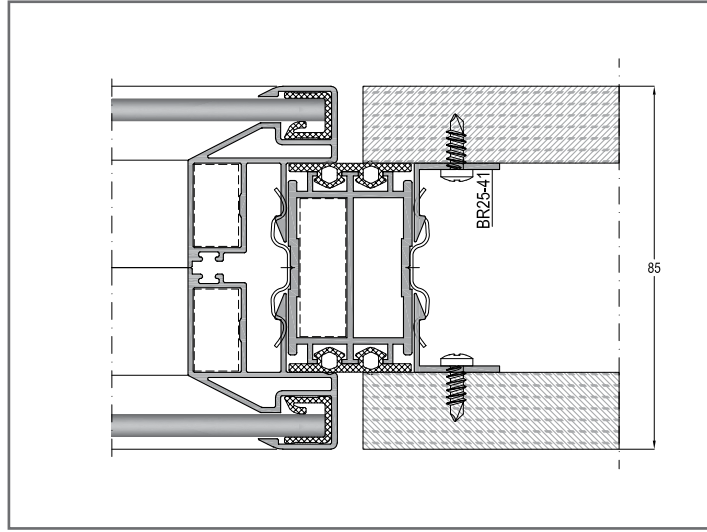

INTERNO 42

TEK CAMLI OFİS BÖLME SİSTEMİ SINGLE GLAZING INTERIOR PARTITION SYSTEM

Sistem Kasa Geniřliđi 42 mm
Frame Width

Cam Kalınlıđı 8 - 10 mm
Glazing

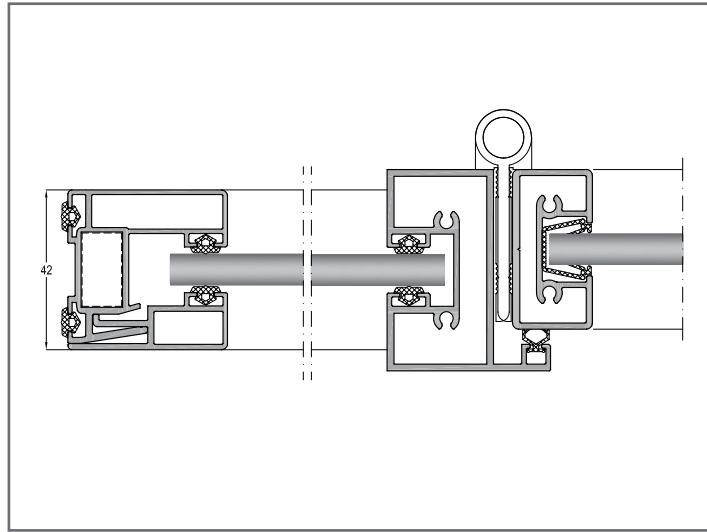

INTERNO KAPI

İÇ MEKAN KAPI SİSTEMİ INTERIOR DOOR SYSTEM

Sistem Pervaz Geniřliđi
System Sill Width

Standart seri	: 68 mm
Standart serial	
Dekoratif pervazlı seri	: 68 mm
Decorative serial	
Dar pervazlı seri	: 40 mm
Narrow serial	
Geniř pervazlı seri	: 80 mm
Wide serial	
Düz pervazlı seri	: 55 mm
Flat serial	

Duvar Kalınlıđı
Wall Thickness

Standart seri	: 110 - 240 mm
Standart serial	
Dekoratif pervazlı seri	: 105 - 240 mm
Decorative serial	
Dar pervazlı seri	: 95 - 300 mm
Narrow serial	
Geniř pervazlı seri	: 200 - 310 mm
Wide serial	
Düz pervazlı seri	: 95 - 210 mm
Flat serial	

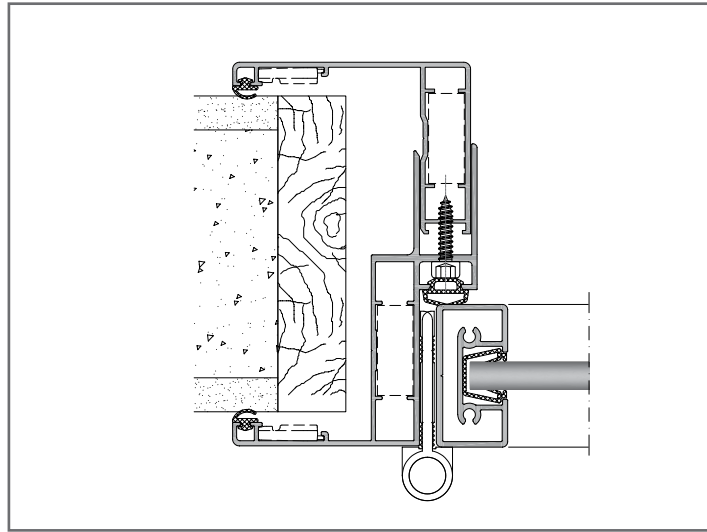

Fabrika / Factory

Adres: Organize San. Bölg.
No: 2, Cad.2 Kırklareli / Türkiye
Tel : 0288 263 44 15
Fax : 0288 263 43 36

Çorlu – Genel Merkez / Head Office

Adres: Hatip Mah.
Ali Osman Çelebi Bulvarı No:54
Çorlu / Tekirdağ / Türkiye
Tel : 0282 652 50 96
Fax : 0282 652 56 76

İstanbul- Bölge Müdürlüğü / District Office

Adres: Prof.Dr.Nevzat Pisak Cad.
Doğu Sanayi Sitesi 8.Blok No:3
Yenibosna / İstanbul / Türkiye
Tel : 0212 654 65 23 / 0212 654 65 24
Fax : 0212 654 65 26

İzmir – Ege Bölge Müdürlüğü / District Office

Adres: 1561 Sok. No:50
Çınarlı / İzmir / Türkiye
Tel : 0232 461 93 14 / 461 60 63
Fax : 0232 461 84 03

Sofya Ofis / Sofia Office

A: 38 Kapitan Dimitar Spisarevski Street
Res.w. Druzhba 1,
Sofia 1592 Bulgaria (Bulgaristan)
Tel : 00359 2 444 00 62
00359 889 170 062
E-mail : office@asistal.bg

